



Distinctively Different... Kountry Star Review—Volume V

1991 Towables



TECHNOLOGY SURROUNDED BY TRADITION



Newmar Corporation:
A sound company backed by
23 years of experience



1991 Towables

BY 

Distinctively Different!

"When we decided to shop for a new camper we had some distinct plans and needs in mind. We needed an RV that was capable of long distance travel, one that could provide comfort in a range of different climates, and could offer convenience and security away from home at a price within our reach. We discovered one that is *Distinctively Different...Kountry Star.*"

"Kountry Star meets our distinct needs and offers everything we wanted in a towable in the mid-price range. There is a great selection of floor plans and options, the tastefully decorated interiors are so warm and practical, they make us feel like we're at home away from home. Kountry Stars are well insulated for comfort in hot or cold climates and the all-aluminum superstructure and heavy steel frame give us the security we need when

traveling down the most rugged roads. Dollar for dollar, we feel we made the best choice in selecting Kountry Star...*Distinctively Different!*"



TRAVEL TRAILER DINETTE



1991 Towables

BY **Newmar Corp.**

Distinctively Different!

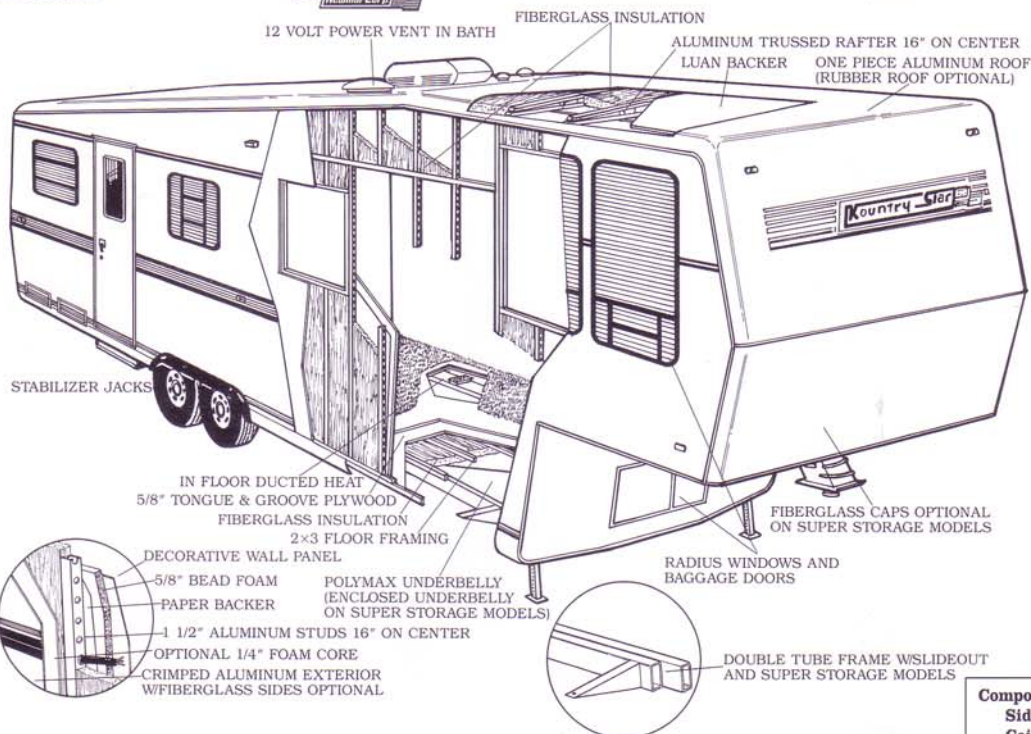

Newmar Kountry Klub

"Don't forget to check out the Klub . . . the Newmar Kountry Klub that is. All you need to be eligible is to be the proud owner of any one of the fine Newmar products."

Composite "R" Factors	
Sidewalls	8.9
Ceiling	9.7
* Floor	9.1

*Does not include motorized

Standards and Options

TT FW AIR CONDITIONING, HEATING & LP GAS

- O O Air Cond. Coleman 13.5 BTU (ea)
- O O Air Cond. Emerson 13.5 Ducted (1)
- O O Air Cond. Emerson 13.5 Ducted (extra)
- O O Air Cond. Prep for 2nd Air, not Ducted
- S S Air Cond. Prep (w/Wiring)
- S NA Cover for LP Gas Bottles - ABS
- S S Furnace 20M Electronic Ignition (Excalibur) (21'-27')
- S S Furnace 25M Electronic Ignition (Excalibur) (29'-35')
- NA S Furnace 31M Electronic Ignition (Excalibur) (36' and up)
- O O Furnace 35M Electronic Ignition ILO Standard (Excalibur) (36' & up)
- O O Heat Strip For Air Cond
- S S Heat in Floor Ducted
- S S LP Gas Bottles 2-20# Steel w/Auto Reg
- O O LP Gas Bottles 2-30# Steel ILO 20# Steel
- O O LP Gas Bottles 2-40# Steel ILO 20# Steel (where applic)

APPLIANCES & ACCESSORIES

- S S Bath Acc. (3-towel bars, tis. hldr, 2-towel rings, 1-robe hook)
- S S Faucet for Lavatory Dbl Handle Mixing
- S S Faucet for Shower Dbl Handle Mixing w/ Spigot
- S S Faucet for Sink Dbl Handle
- S S Faucet for Sink Single Handle
- O O Microwave Oven Conv 30" (Sharp) w/4-Burner Hot Plate ILO Std Range (except 20')
- O O Microwave Oven 22"
- S S Microwave Prep 22 1/4" W x 15" H
- S S Range 4-Burner Porcelain w/Pilot Top & Oven (27' & up)
- O O Range Larger 4-Burner Porcelain, Blk Glass Door w/Pilot Top & Oven (except 20')
- O O Range Cover Bi-Fold Deluxe
- S S Range Hood w/Light & Fan
- O O Refri Norcold Double Door 682 ILO 452 (27' & up)

TT FW

- O O Refri Norcold Double Door 683 3-Way ILO 452 (27' & up) (where applic)
- S S Refri Norcold Single Door 452 2-Way (27' & up)
- O O Refri Norcold Double Door 662 ILO 452 (27' & up)
- NA O Shower Fiberglass 36" w/Remainder WRB (where applic)
- S S Sink Dbl Porcelain
- S S Stool Aqua Magic Starlite
- O O Stool w/Water Saver (spray attachment)
- NA O Tub 40" ILO 54" w/Remainder Wardrobe ILO Std (where applic)
- O O Tub/Shower Fiberglass ILO Std
- NA O Tub Corner w/Enclosure ILO Std (where applic)
- S S Tub ABS w/Curtain
- S S Tub Surround
- O O Tub or Shower Enclosure
- NA O Washer/Dryer Sears 2 Piece (certain models)
- NA O Washer/Dryer Prep-Plumbing, Recept & Shelf (certain models)
- O O Water Heater Bypass Kit
- S S Water Heater Gas 6 Gal
- O O Water Heater Gas 6 Gal w Elect. Ign.
- O O Water Heater Gas/Elec 10 Gal (29' & up) (where applic)
- O O Water Heater Reignitor 12V

CABINETS & FURNITURE

- O O Bed Queen (60" x 75") (where applic)
- NA O Bed Dbl Island ILO Std (where applic)
- O O Bed Twin (32" x 75") ILO Double (where applic)
- O O Bunk Cabinet w/3" Foam Mat, 8 x 14 Window ILO 91" Sofa OH
- O NA Bunk Cabinet w/3" Foam Mat, 8 x 14" Window Above Twin Bed (ea) (where applic)
- O NA Bunk House ILO Std (26RBT)
- S S Cabinetry Oak w/ Hardwood Frame Doors
- O O Chair Free Stndg Pedestal
- O O Chair Swivel Rocker

TT FW

- O O Counter Top Extension (where applic)
- NA O Deluxe Honeymoon Suite Bedroom (Must Add SS Opt) (30' & up)
- O O Dinette Drop Leaf Table w/2 Hardwood Chairs (where applic)
- S S Dinette w/Inner Springs & Fabric Covered Ends (see Floor plan)
- O O Doors Oak Cabinet over Decorative Shelves
- O O Drawers Wood w/Metal Guides & Side Rollers
- O O Drawer below Dinette Seat (ea)
- O O Entertainment Center Base Only (where applic)
- O O Lifts for Convenient Storage Under Fixed Beds (ea)
- O O Sofa 75" w/End Tables ILO 84" Sofa
- O O Table Dropleaf high-low

ELECTRICAL & LIGHTING EQUIPMENT

- S S Battery 115 AMP Sears Die Hard Deep Cycle
- S S Converter 40 AMP w/Charger
- O O Converter 50 AMP w/Charger
- S S Electrical Service 30 AMP
- O O Electrical Service 50 AMP
- O O Electrical Service Prep for 50 AMP
- NA O Gen 6.5 kw Onan w/1 Remote Switch, Gas Tank & Battery (30' & up)
- NA O Gen Prep (110V /wire, remote start wire & door)
- NA O Ceiling Light Prep, 110V w/Wall Switch
- O O Lighting Fluorescent Dbl Surface Mount (ea) (Choose Location)
- O O Light Exterior Security (ea) (Choose Location)
- S S Monitor Panel
- O O Radio/Ant, AM/FM Stereo Cass, Clock
- S S Recept 110V GFI (interior & exterior)
- S S Stereo Antenna & 4 Speakers
- O O Telephone Jack Interior (Ea, Choose Location)
- S S TV Antenna Prep (Wire, Shelf & 2 Jacks)
- O O TV Antenna w/Power Booster & Jack(s)
- O O TV Jack Exterior on Door Side
- S S TV Cable Hook Up
- O O VCR Prep (where applic)
- NA O TV Satellite Dish 6' (where applic)

EXTERIOR ACCESSORIES

- S S Bumper Cover Aluminum
- S S Bumper w/Sewage Hose Storage
- S NA Exterior Front & Rear Wrap Around Smooth Metal
- NA O Exterior Front & Rear Gelcoated Fiberglass End Caps ILO Metal (SS Only)
- O O Exterior Sides Gelcoated Fiberglass (per ft)
- O O Roof Rack & Ladder
- O O Roof Rubber
- S S Roof One Piece Aluminum
- NA O Slide Out 65" w/Lights (Choose Cabinet & Furniture Selection)
(Where applic)
- NA O Slide Out 71" w/Cabover (Choose Cabinet & Furniture Selection)
(Where applic)
- O O Slide Out 76" w/Lights (Choose Cabinet & Furniture Selection)
(Where applic)
- NA O Slide Out 91" w/Lights (Choose Cabinet & Furniture Selection)
(Where applic)
- NA O Slide Out 101" w/Lights (Choose Cabinet & Furniture Selection)
(Where applic)
- O NA Step Dbl Manual ILO Single
- NA S Step Dbl Manual
- NA O Super Storage w/Enclosed Underbelly & Carpeting
- NA O SS 5200 # Axles H78 x 15 D Tires (Except 40')
- NA O SS 75" Entrance Door
- NA O SS Enclosed Underbelly
- NA O SS Triple Step

INTERIOR FEATURES

- O O Bedspread Quilted w/Matching Shams & Accent Pillow (ea)
- S S Ceiling Woven Soft Touch
- O O Countertop Ceramic Tile
- O O Kountry Aire Decor Package
- O O Vinyl Foyer
- S S Floor Covering, Carpet w/Pad Living Room
- S S Floor Covering, Carpet w/Pad Bedroom
- S S Floor Covering, Vinyl in Kitchen & Bath
- O O Floor Covering, Carpet w/ Pad ILO Vinyl (Per Ft) (Choose Location)
- O O Carpet Pad Deluxe
- NA S Stand Up Bedroom Area (30' & Up)
- S S Window Treatment Mini Blinds
- S S Window Treatment Roller Shades w/Drapes/Val & Tie Backs (Bedrm)
- O O XL Package Interior & Exterior
- O O XL Bath Accessories Brass

TT FW

- O O XL Bath Lav & Tub Faucet Deluxe Brass
- O O XL Kitchen Faucet Single Handle Brass
- O O XL Bedspread Quilted w/Matching Shams (1 Dbl or 1 Queen or 1 pr Twins)
- O O XL Bifold Range Cover
- O O XL Black Glass Door on Larger Oven
- O O XL Black Glass Door on Refri
- O O XL Stainless Steel Lug Nuts
- O O XL Deluxe Brass Complexion Light in Bathroom w/Wall Switch
- O O XL Deluxe Din Light w/Wall Switch
- O O XL Deluxe Raised Panel Doors ILO Std
- O O XL LP Gas Bottles Steel 30# ILO 20#
- O O XL Sofa Throw Pillows
- O O XL Lifts for Convenient Storage Under Fixed Beds
- O O XL Radio/Ant, AM/FM Stereo, Cass, Clock & 4 Spkr (CBD Models 6 Spkr)

PLUMBING SYSTEMS

- S S Insulated Holding Tanks
- S S Tank Gray Water 48 Gal (Approx)
- S S Tank Sewage Holding 48 Gal (Approx)
- S S Water Capacity 42 Gal (Approx)
- S S Water System Demand w/12V Pump & 5/8" Polybutylene Lines

RUNNING GEAR & CONSTRUCTION

- NA O 102" Wide Body
- S S Frame Size 5" Tube (27'-29')
- S S Frame Size 6" Tube (30' & up)
- S S Frame Size Double Tube (40' & w/PSO)
- NA O 12000 LB Hitch Plate & Bracket Center Mount (up to 12000 LB GVWR)
- NA O 15000 LB Hitch Plate & Bracket Center Mount
- O O Insulation 1/4" Fome-Cor Complete Exterior (w/metal only)
- O O Insulation 1/4" Fome-Cor Floor, Roof & Ends (w/fiberglass sides)
- S S Insulation Laminated 5/8" Foam in Sidewalls & Ceiling
- O O Insulation Polar Pak (R7 Sidewalls & Floor-- R10 Roof)
- S S Insulation R5 Fiberglass in Sidewalls, Roof & Floor
- NA O Jacks Stabilizer (set of 2)
- NA S Jacks Stabilizer (set of 2)
- O NA Jacks Stabilizer (set or 4)
- O O Jack(s) for Hitch 12V Power
- S S Shock Absorbers
- O O Skid Bars for Rear Bottom Protection
- O O Spare Tire Cover Deluxe (27' & up)
- O O Spare Tire & Carrier (15")
- O O Spare Tire & Carrier (16")
- S S Structure Aluminum Sidewalls & Roof
- O O Tires Radial 15" ST225 ILO Std (ea) (27' & up)
- O O Tires Radial 16"
- O O Tires Radial 16" w/5200# Axle (Tandem Axle) (for non ss only)
- NA O Tires Radial 16" w/5200# Axle (Triple Axle) (40' only)
- O O Underbelly Enclosed w/Fiberglass Insulation
- O O Underbelly Metal ILO Polymax
- O O Radius Bottom Wrap

SAFETY FEATURES

- O O Customer Pick Up
- O O LP Leak Detector
- S NA Safety Chains
- O O State Seal

WINDOWS, DOORS, AWNINGS & VENTS

- S NA Awning Front
- O O Awning Per Window Matching Side Awning (A&E 9000) (Choose Location)
- O O Awning Per Window Matching Side Awning (A&E 8500) (Choose Location)
- O O Awning Rear (where applic)
- O O Awning Side A&E 8500
- O O Awning Side A&E 9000
- O O Awning Tension Rafter for Side Awning
- O O Door Bell
- O O Door 30" Entrance (where applic)
- S S Lock Dead Bolt (ea)
- O O Skylight in Bathroom w/Soft Shade (27' & up)
- O O Vent Non Power (Choose Location)
- S S Vent 12V in Bath Area w/Wall Switch
- O O Vent 12V in Ceiling w/Wall Switch (Choose Location)
- O O Vent 12V Fantastic 3-spd w/Wall Thermostat & Power Opener
(Choose Location)
- NA O Window Picture 48 x 48 ILO 22 x 42 at Cabover
- O O Window Picture 48 x 48 ILO 29 x 48 at Dinette
- S S Windows Radius Torque Reg Glass
- O O Windows Radius Torque Safety Glass ILO Reg
- O O Windows Safety Glass Storms (Except Slide Out)

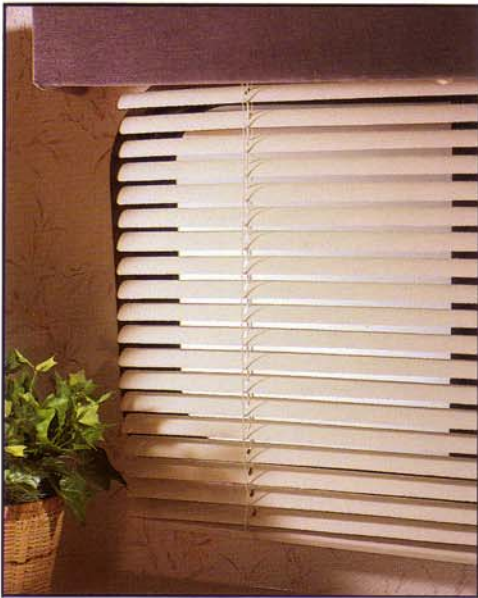

TEXTURED MINI BLINDS



SWIVEL ROCKER



FIFTH WHEEL GALLEY

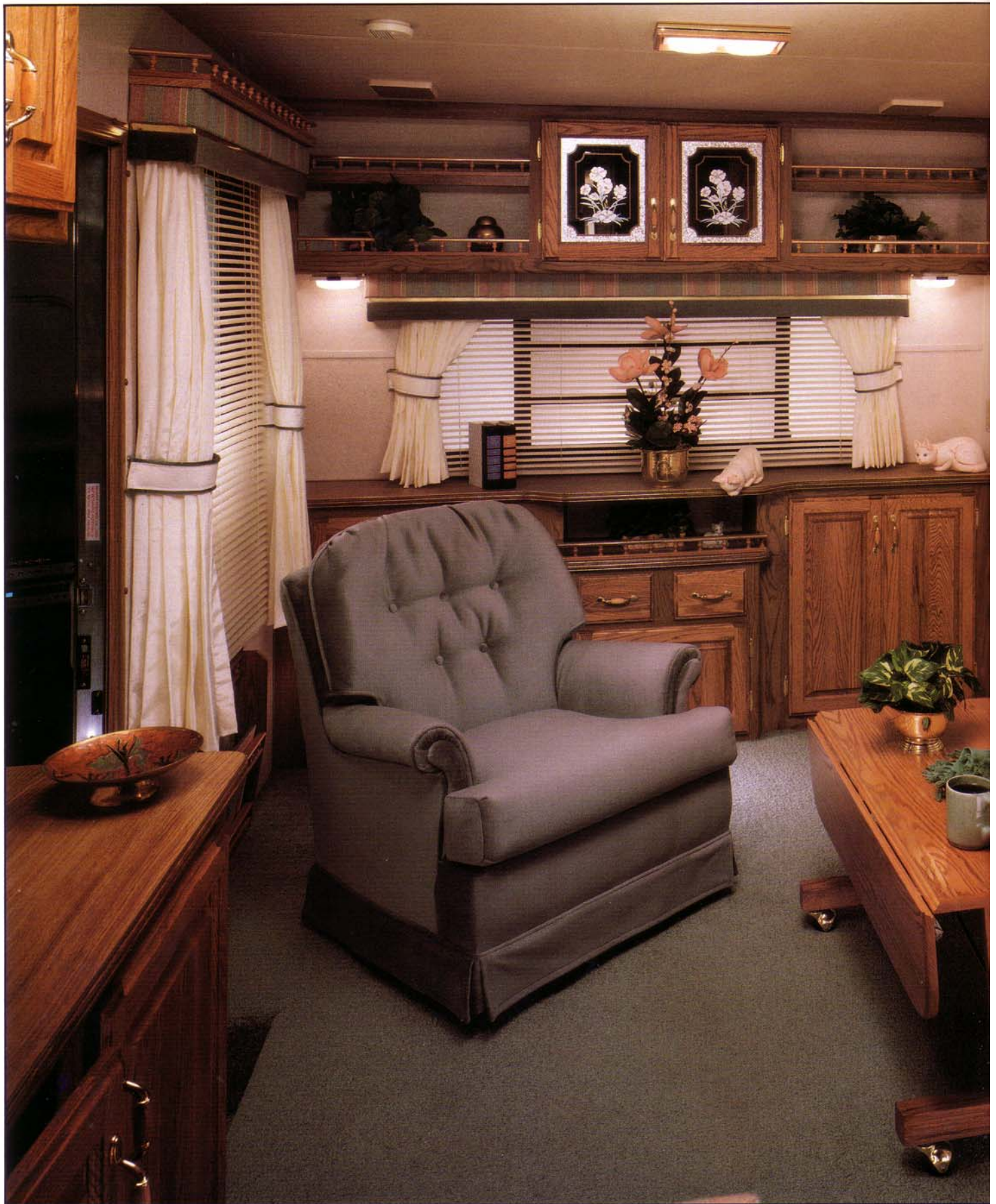

FIFTH WHEEL LIVING AREA



BEVELLED ACCENT MIRROR

"Kountry Star meets our distinct needs and offers everything we wanted in a towable in the mid-price range. There is a great selection of floor plans and options, the tastefully decorated interiors are so warm and practical, they make us feel like we're at home away from home."



GOLD FAUCET

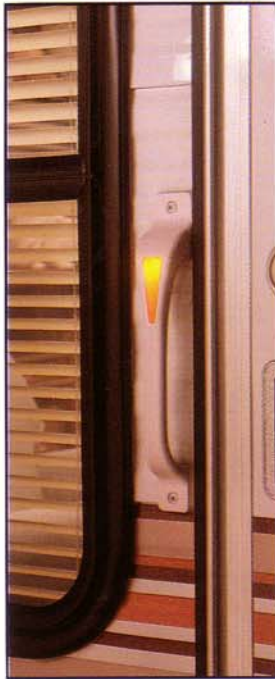

LIGHTED GRAB
HANDLE



4 CUBE LIGHT



SOFT TOUCH CEILING



FIFTH WHEEL BATH

FIFTH WHEEL FLOOR PLANS

27 SB

29 WRKD

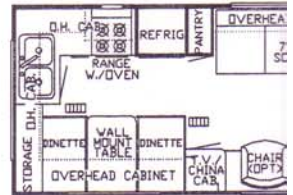

32 WD

32 FL/SS

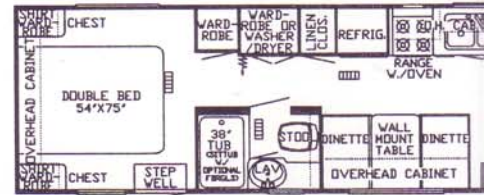

36 WD



Option A

Option B

Option C

Option D

Option E

Option F



Option M

Option N

Option O

Option P

Option 9

Option R

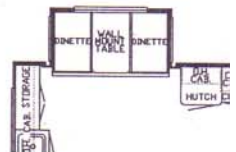

TRAVEL TR

Option A

Option B

Option C

Option D

Option E

Option F

Option G

Option 1



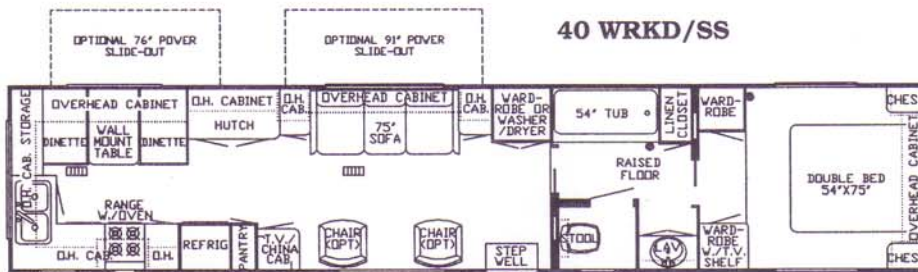
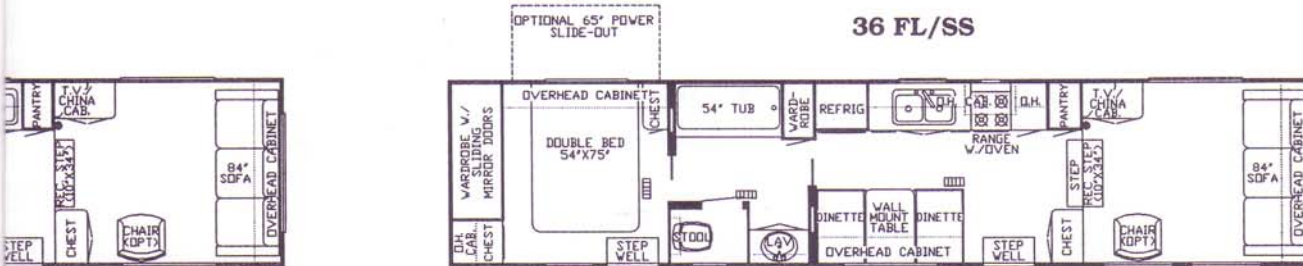
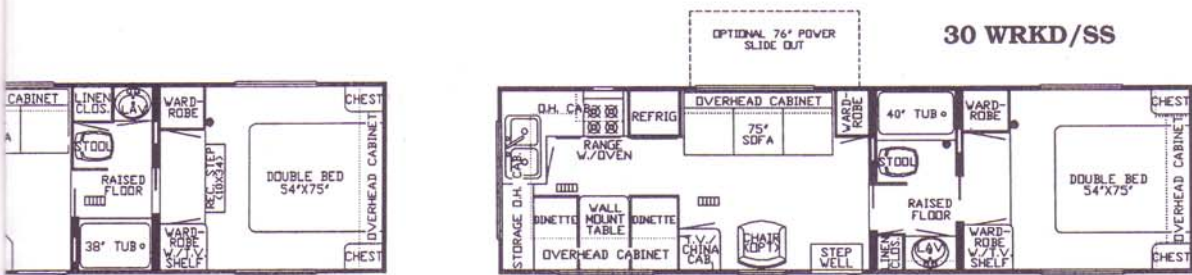

DEL OPTIONS

Option G



Option H



Option I

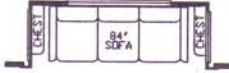

Option J

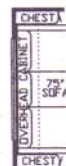

Option K



Option L



Option S

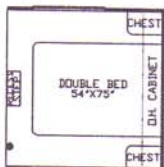

Option T

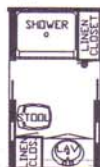

Option U



Option V



Option X

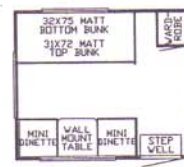

AILER OPTIONS

Option I

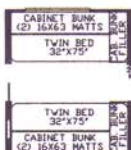

Option J



Option K



Option L

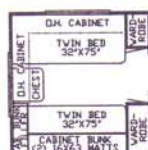

Option M

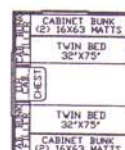

Option N

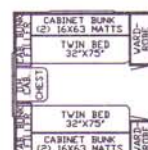

Option O

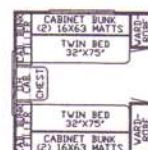

Travel Trailer Specifications

MODEL	FACTORY WEIGHT*	GVWR*	AXLE WEIGHT*	HITCH WEIGHT*	TIRES	WHEELS	HEIGHT W/AC	LENGTH	WIDTH	OPTION
26 CBD	5,050	7,340	4,450	600	F78 X 15C	15 X 5	10' 5"	26' 11-1/2"	95"	A.G.J.M
26 FKD	5,050	7,340	4,450	600	F78 X 15C	15 X 5	10' 5"	26' 11-1/2"	95"	G
26 RBT	5,050	7,340	4,450	600	F78 X 15C	15 X 5	10' 5"	26' 11-1/2"	95"	I
30 FKD	5,550	7,340	4,825	725	F78 X 15C	15 X 5	10' 5"	31' 1/4"	95"	B.G.K.N
31 CBD	6,775	7,540	5,000	775	F78 X 15C	15 X 5	10' 5"	31' 5-1/2"	95"	B.D.E.H.L.O.
33 FKD	6,000	7,640	5,200	800	F78 X 15C	15 X 5	10' 5"	33' 2-1/2"	95"	B.G.K.N
35 CBD	6,600	8,940	5,700	900	H78 X 15C	15 X 5	10' 5"	35' 1/2"	95"	B.C.D.E.F.H.L.O

Fifth Wheel Specifications

MODEL	FACTORY WEIGHT*	GVWR*	AXLE WEIGHT*	HITCH WEIGHT*	TIRES	WHEELS	HEIGHT W/AC	LENGTH	WIDTH	OPTION
27 SB	5,500	7,895	4,300	1,200	F78 X 15C	15 X 5	10' 11"	27' 7"	95"	A.M.S
29 WRKD	6,300	8,090	5,050	1,250	F78 X 15C	15 X 5	10' 11"	29' 9"	95"	B
30 WRKD/SS	7,000	10,185	5,700	1,300	H78 X 15D	15 X 6	12' 3"	30' 4"	95"	B.F.M.Q
32 FL/SS	7,500	10,095	6,100	1,400	H78 X 15D	15 X 6	12' 9"	33' 1"	95"	
32 WD	7,200	9,440	5,900	1,300	H78 X 15D	15 X 6	12' 3"	33' 1"	95"	B.F.J.L.M.(Q)
32 WRKD/SS	7,400	10,780	6,100	1,300	H78 X 15D	15 X 6	12' 3"	33' 1"	95"	
36 FL/SS	8,050	11,385	6,050	2,000	H78 X 15D	15 X 6	12' 9"	37' 7"	95"	C.D.E.K.O.X
36 WD	7,500	9,640	6,000	1,500	F78 X 15C	15 X 6	12' 3"	37' 7"	95"	B.G.H.J.L.M.N.O U.V.(Q)
36 WRKD/SS	8,050	10,880	6,650	1,400	H78 X 15D	15 X 6	12' 3"	37' 7"	95"	
40 WRKD/SS	9,100	12,000	7,600	1,500	F78 X 15C	15 X 5	12' 3"	39' 11"	95"	B.G.H.M.O.Q.R.U.V

*WITHOUT OPTIONS

#SOME OPTIONS MAY ALLOW GREATER RATINGS

()OPTIONS IN PARENTHESES ARE AVAILABLE ON SS ONLY



Newmar Corporation features appliances and components by these quality names to insure you of years of safe and trouble-free operation and enjoyment.

LEGEND

FLOOR PLANS

RBD - Rear Bath Dinette
 CBD - Center Bath Dinette
 FKD - Front Kitchen Dinette
 RBT - Rear Bath Twin Bed
 SB - Side Bath
 WRKD - Walk Through Bath
 Rear Kitchen w/Dinette

FL - Front Lounge
 WD - Walk through w/ Dinette
 SS - Super Storage
 DB - Double Bedroom

SPECIFICATIONS

ILO - In Lieu Of
 KS - Kountry Star

TRAVEL TRAILER FLOOR PLANS

1991 TOWABLES

26 CBD

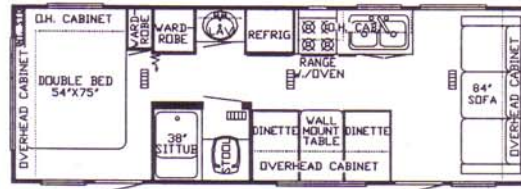

26 FKD

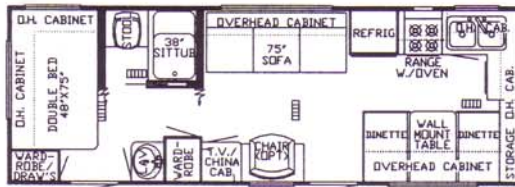

26 RBT

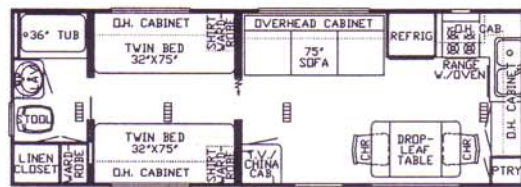

30 FKD

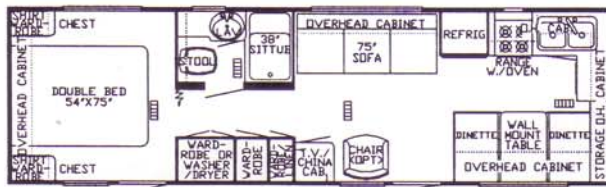

31 CBD

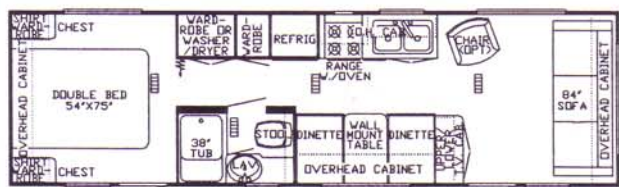

33 FKD

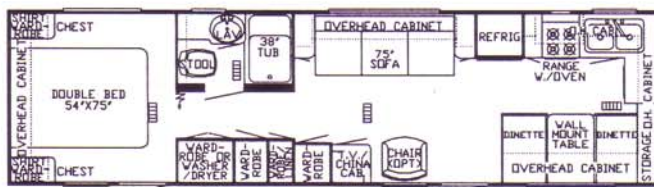

35 CBD

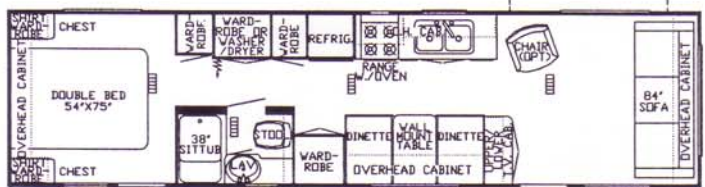

Quality is #1 at Newmar Corporation, and our "Personal Touch" inspection of all products will insure you of that high quality before any RV ever leaves our plant!

Kountry Star Interior Color Packages



KS-1-74 ROSE GARDEN



KS-1-75 BLUE MIST



KS-1-76 MAUVE ROSE



KS-1-77 BLUE CLOUD

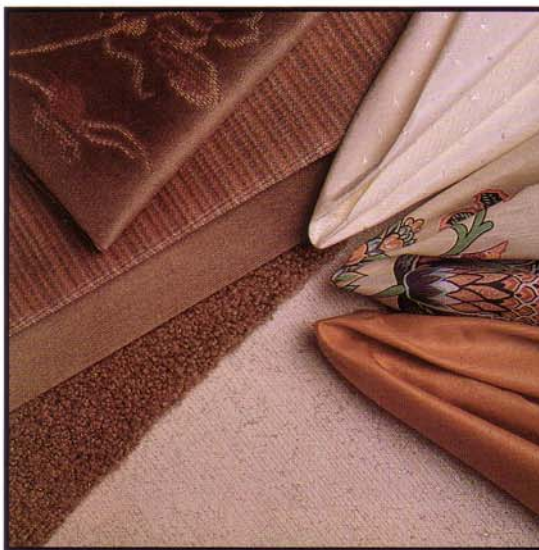

KS-1-78 SATIN WOOD



KS-1-80 TEAL HORIZON

Kountry Star...Distinctively Different!



FIFTH WHEEL BEDROOM



"We needed an RV that was capable of long distance travel, one that could provide comfort in a range of different climates, and could offer convenience and security away from home at a price within our reach. We discovered one that is *Distinctively Different ...Kountry Star.*"

Your nearest Kountry Star dealer:



Kountry Star 
1991 Towables 

Newmar Corporation, 355 North Delaware
Nappanee, IN 46550-0030, (219) 773-7791

Scheduled plant tours Monday-Friday

Prices and specs are subject to change without
written notice at Newmar's discretion with no
obligation.

9-90