

1991 *Motorhomes*



TECHNOLOGY SURROUNDED BY TRADITION!



KOUNTRY STAR • KOUNTRY AIRE • LONDON AIRE



"We weren't quite sure what type, brand or price of motor home we wanted, we just knew we were ready to move into the motorized world of recreational vehicles. With so many styles and brands, it was a little confusing until we stopped by a **Newmar Corporation** dealership. When we found out how many different brands, types, and price ranges they had to offer, we knew we had found a one-stop place to shop"

"We trust the **Newmar** name for quality and service and with their endless selection of motorhomes, we knew we couldn't go wrong. All their motorhomes are carefully designed by knowledgeable and experienced engineers who are seasoned campers themselves and understand exactly what today's motorhome enthusiast needs *and* wants. They have a motorhome to fit any situation and budget. **Newmar Corporation** truly is Technology

Surrounded by Tradition. Our only remaining problem is trying to decide which of these great coaches we'll drive away in."



Quality is #1 at **Newmar** Corporation, and our "Personal Touch" inspection of all products will insure you of that high quality before any RV ever leaves our plant!

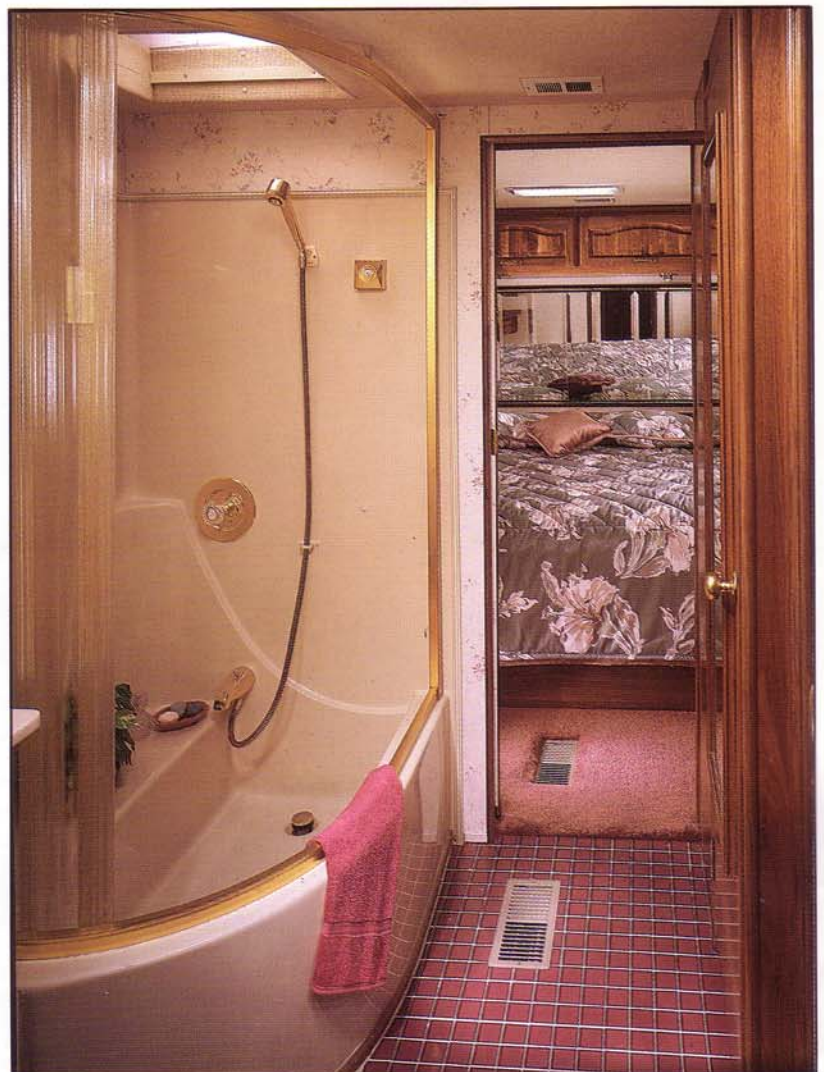

LONDON AIRE CLASS A BATHROOM/BEDROOM



1991 Motorhomes

- Dutch Star
- Kountry Star
- Kountry Aire
- London Aire

Technology Surrounded By Tradition!



ALL ALUMINUM SUPERSTRUCTURE

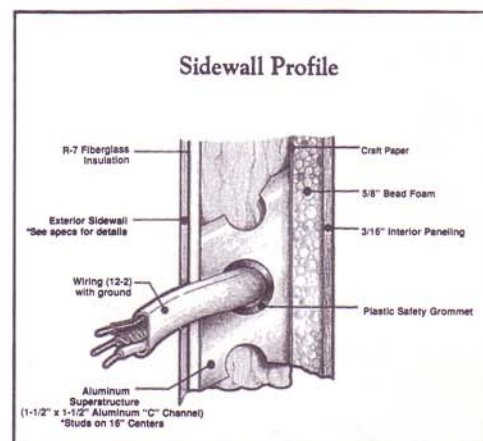
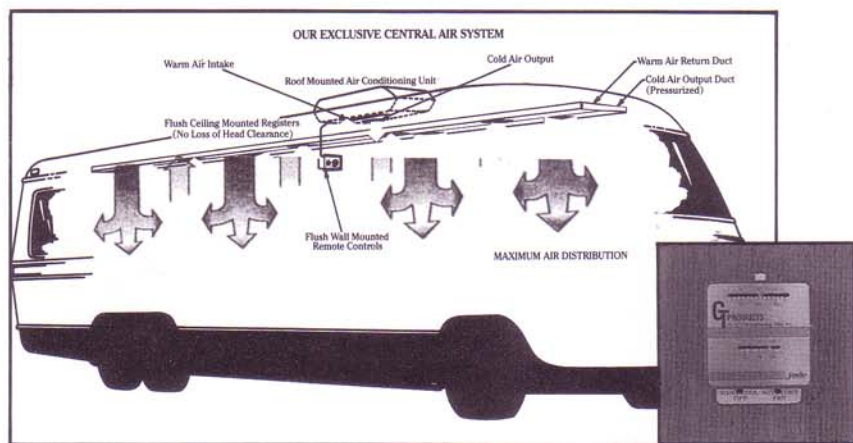

SIDEWALL PROFILE

Newmar Warranties are your assurance of Confident buying!



MOTORIZED Standards and Options

MI	MI	CA	CA	CA	CA	RETAIL	AIR CONDITIONING, HEATING & LP GAS
KS	KA	LA	DS	KS	KA	LA	Air Cond. Central Coleman 13.5 BTU w/Wall Thermostat (1)
NA	NA	S	NA	NA	S	S	Air Cond. Coleman 13.5 BTU (ea)
O	NA	NA	NA	O	NA	NA	Air Cond. Central Coleman 13.5 BTU w/Wiring & Wall Thermostat (extra)
NA	NA	O	NA	NA	O	O	Air Cond. Emerson 13.5 Ducted (1)
O	S	NA	S	O	NA	NA	Air Cond. Emerson 13.5 Ducted (extra)
O	O	NA	NA	O	NA	NA	Air Cond. Prep for 2nd Air, Not Ducted
O	NA	NA	NA	O	NA	NA	Air Cond. Prep (w/Wiring)
S	NA	NA	NA	S	NA	NA	Furnace 20M Electronic Ignition (Excalibur) (21'-27')
S	NA	NA	NA	S	NA	NA	Furnace 25M Electronic Ignition (Excalibur)
NA	NA	NA	S	S	NA	NA	Furnace 31M Electronic Ignition (Excalibur)
NA	S	S	NA	NA	NA	NA	Furnace 31M Electronic Ignition (Excalibur) (36' & up)
NA	NA	NA	NA	S	NA	NA	Furnace 35M Electronic Ignition ILO Std. (Excalibur) (36'&up)
O	NA	NA	NA	O	NA	NA	Furnace 35M Electronic Ignition (Excalibur)
NA	NA	NA	NA	S	S	S	Heat Strip for Air Cond.
O	O	NA	O	O	NA	NA	Heat in Floor Ducted
S	S	S	S	S	S	S	LP Gas Tank 15 Gal.
S	S	S	S	S	S	S	LP Gas Tank 32 Gal. ILO 15 Gal.
NA	NA	O	O	O	O	O	
NA	NA	NA	NA	NA	NA	NA	APPLIANCES & ACCESSORIES
NA	NA	NA	NA	NA	NA	NA	Bath Acc. (1-towel bar, tis. hldr., 1-towel ring) Brass
S	NA	NA	S	S	NA	NA	Bath Acc. (3-towel bars, tis. hldr., 2-towel rings, 1-robe hook)
NA	S	S	NA	NA	S	S	Bath Acc. (1-towel bar, tis. hldr., 1-towel ring, 1-robe hook)
NA	NA	S	NA	NA	NA	S	Clothes Line in Tub/Shower (Retractable)
S	NA	NA	S	NA	NA	NA	Faucet for Lavatory Dbl. Handle Mixing
NA	S	NA	NA	S	S	NA	Faucet for Lavatory Dbl. Handle Mixing (Brass)
NA	NA	S	NA	NA	NA	S	Faucet for Lavatory Deluxe Single Handle w/Pop up Plug (Gold)
S	NA	NA	S	NA	NA	NA	Faucet for Shower Dbl. Handle Mixing w/Spigot
S	S	NA	NA	S	S	NA	Faucet for Shower Dbl. Handle w/Spigot (Brass)
NA	NA	S	NA	NA	NA	S	Faucet for Shower Single Handle w/Spigot (Gold)
S	NA	NA	S	NA	NA	NA	Faucet for Sink Dbl. Handle
NA	NA	S	NA	NA	NA	S	Faucet for Sink Handle Deluxe Hi Rise (Chrome)
NA	S	NA	NA	S	NA	NA	Faucet for Sink Single Handle
NA	O	S	NA	NA	O	S	Blender
O	NA	NA	NA	O	NA	NA	Microwave Oven Conv. 30" (Sharp) w/4 Burner Hot Plate ILO Std. Range
NA	O	NA	NA	NA	NA	NA	Microwave Oven Conv. 30" (Sharp) w/4 Burner Hot Plate ILO Std. Range
NA	NA	S	NA	NA	S	S	Microwave Oven Convection 30" (Sharp) w/Light/Fan & Hot Plate
NA	O	NA	NA	NA	NA	NA	Microwave Oven Spacemaker CE
O	O	NA	S	O	NA	NA	Microwave Oven 22"
NA	NA	NA	NA	NA	NA	NA	Microwave Oven 22"
S	S	NA	NA	S	NA	NA	Microwave Prep 22-1/4" W X 15" H
NA	NA	NA	S	NA	NA	NA	Range 2-Burner Plate
NA	S	NA	NA	NA	NA	NA	Range 4-Burner 22" w/Pilot Top & Oven
S	NA	NA	NA	S	NA	NA	Range Larger 4-Burner Porcelain, Blk. Glass Door w/Pilot Top & Oven (except 20')
NA	NA	NA	O	NA	NA	NA	Range Larger 4-Burner Porcelain, Blk. Glass Door w/Pilot Top & Oven
O	S	S	O	S	S	S	Range Cover Bi-Fold Deluxe
S	S	NA	S	S	NA	NA	Range Hood w/Light & Fan
NA	O	S	NA	O	S	S	Refrl. Dometic Double Door 3804 AES
NA	NA	NA	O	NA	NA	NA	Refrl. Norcold Double Door 682 ILO 462
NA	NA	NA	NA	O	NA	NA	Refrl. Norcold Double Door 682 ILO 662
O	NA	NA	NA	NA	NA	NA	Refrl. Norcold Double Door 682 ILO 452
NA	S	NA	NA	NA	S	NA	Refrl. Norcold Double Door 683 3-Way
O	NA	NA	NA	NA	NA	NA	Refrl. Norcold Double Door 683 3-Way ILO 452
NA	NA	NA	NA	NA	NA	NA	Refrl. Norcold Single Door 442 2-Way
S	NA	NA	NA	NA	NA	NA	Refrl. Norcold Single Door 452 2-Way
NA	NA	NA	S	NA	NA	NA	Refrl. Norcold Double Door 462 2-Way
O	NA	NA	NA	NA	NA	NA	Refrl. Norcold Double Door 662 ILO 452
NA	NA	NA	NA	S	NA	NA	Refrl. Norcold Double Door 462 ILO 442
NA	NA	NA	NA	NA	S	NA	Refrl. Norcold Double Door 662 2-Way

MI	MI	MI	MI	CA	CA	CA	CA	RETAIL	APPLIANCES & ACCESSORIES cont.
DS	KS	KA	LA	DS	KS	KA	LA		Icemaker (110V)
NA	NA	NA	S	NA	NA	NA	S		Safe (where applic.)
NA	NA	O	O	NA	NA	O	O	\$478	Shower Exterior Hook Up
NA	NA	NA	NA	NA	O	O	NA	\$168	Sink Dbl. Porcelain
S	S	S	S	S	S	S	S		Stool Aqua Magic III
S	NA	NA	NA	S	NA	NA	NA		Stool Aqua Magic Starlite
NA	S	S	NA	NA	S	S	NA		Stool China
NA	NA	O	S	NA	NA	O	S	\$59	Tub or Shower Fiberglass
NA	S	S	S	NA	S	S	S		Tub Surround
S	NA	NA	NA	S	NA	NA	NA		Tub or Shower Enclosure
NA	O	S	S	NA	O	S	S	\$153	Tub Enclosure
O	NA	NA	NA	O	NA	NA	NA	\$122	Vacuum System Portable
NA	NA	NA	S	NA	NA	NA	S		Washer/Dryer Sears 2 piece (certain models)
NA	NA	NA	NA	NA	O	O	O	\$1,179	Washer/Dryer Prep-Plumbing, Recept. & Shelf (certain models)
NA	NA	NA	NA	NA	O	O	O	\$278	Waste Basket
NA	NA	S	S	NA	NA	S	S		Water Heater Bypass Kit
NA	O	O	S	NA	O	O	S	\$50	Water Heater Gas 6 Gal.
S	NA	NA	NA	S	NA	NA	NA		Water Heater Gas 6 Gal. w/Elect. Ign.
NA	S	S	NA	NA	S	S	NA		Water Heater Gas/Elec. 6 Gal.
O	NA	NA	NA	O	NA	NA	NA	\$83	Water Heater Gas/Elec. 10 Gal. w/Reignitor
NA	NA	NA	NA	NA	O	O	NA	\$15	Water Heater Gas/Elec. 6 Gal. Fast Recovery w/Elect. Ign.
NA	NA	NA	S	NA	NA	NA	S		Water Heater w/Engine Assist
NA	NA	O	S	NA	NA	O	S	\$166	Water Filtering System (Kitchen & Icemaker)
NA	NA	NA	NA	O	NA	NA	NA		CABINETS & FURNITURE
NA	NA	NA	NA	O	NA	NA	NA	\$110	Bed Queen (60" X 75") (where applic.)
NA	NA	NA	NA	O	NA	NA	NA	\$65	Bed Queen (60" X 75") (where applic.)
NA	NA	NA	NA	NA	NA	O	S	\$109	Bed Queen (60" X 75")
O	O	O	O	NA	NA	NA	NA	\$69	Bed Dbl. Island ILO Std. (where app.)
NA	NA	NA	O	NA	NA	NA	O	\$334	Bed Twin (32" X 75") ILO Double
O	O	NA	NA	O	O	NA	NA	\$159	Bed Twin (32" X 75") ILO Double (where app.)
NA	NA	O	NA	NA	NA	O	NA	\$167	Bed Twin (32" X 75") ILO Double
NA	NA	O	S	NA	NA	O	S	\$573	Air Mattress for Queen or Twin Beds (1 pr.)
S	S	NA	NA	S	NA	NA	NA		Cabinetry Oak w/Hardwood Frame Doors
NA	NA	S	NA	NA	NA	NA	NA		Cabinetry Oak w/Raised Panel Doors
NA	NA	NA	O	NA	NA	NA	O		Cabinetry Oak w/Raised Panel Doors ILO Walnut
NA	NA	O	NA	NA	S	S	NA	\$1,104	Cabinetry Oak Hardwood w/Raised Panel Doors
NA	NA	NA	S	NA	NA	NA	S		Cabinetry Walnut Hardwood w/Raised Panel Doors
NA	O	O	NA	NA	O	O	NA	\$44	Counter Top Extension (where applic.)
NA	O	O	O	NA	O	NA	NA		Dinette ILO Sofa
NA	S	S	S	NA	S	S	S		Dinette w/Inner Springs & Fabric Covered Ends (see floor plan)
NA	NA	O	NA	NA	NA	O	NA	\$170	Drawers Wood w/Metal Guides & Side Rollers
NA	O	NA	S	NA	O	NA	S	\$79	Drawer Below Dinette Seat (ea.)
NA	O	O	O	NA	NA	NA	NA		Entertainment Center ILO Curtains, Matt. & Windows
S	O	S	S	S	S	S	S	\$70	Lifts for Convenient Storage Under Fixed Beds (ea.)
NA	NA	NA	S	NA	NA	NA	S		Pantry Slide-out (see floor plan)
NA	NA	NA	NA	O	O	O	NA	\$509	Seat 6-Way Power ILO Std.
S	S	S	S	S	S	NA	NA		Seat Driver 6-Way Power Swivel & Recliner
NA	NA	NA	NA	NA	NA	O	S	\$1,298	Seat Driver/Passenger Swivel & Recliner
S	S	S	S	S	S	S	S		Seat Driver/Passenger 6-Way Power Swivel & Recliner Leather/Vinyl Comb
NA	O	O	NA	O	O	O	NA	\$254	Snack Tray
									Sofa w/Pedestal Table ILO Dinette (where applic.)
									CHASSIS FEATURES
S	S	S	S	S	S	S	S		Brakes Power
NA	NA	NA	NA	S	S	S	S		Chassis-Chevy (454 CID Engine) w/Radial Tires
S	S	NA	NA	NA	NA	NA	NA		Chassis-Chevy (350 CID Engine) w/Polyester Tires w/35 Gal. Tank (22')
NA	NA	NA	S	NA	NA	NA	NA		Chassis-Ford (460 CID Engine) w/Radial Tires w/36 Gal. Tank
S	S	S	NA	NA	NA	NA	NA		Chassis-Ford (460 CID Engine) w/Radial Tires w/36 Gal. Tank (26' & up)
O	O	NA	NA	NA	NA	NA	NA		Chassis-Ford (460 CID Engine) w/Radial Tires w/36 Gal. Tank (22' only)



KOUNTRY STAR MINI LIVING AREA



STAR LAMBREQUIN



STAR OPTIONAL CERAMIC COUNTER TOP



LONDON AIRE CLASS A (OPTIONAL SLIDE OUT)

KA-1-87
LA-1-94
SHADOW BLUE

KA-1-88
LA-1-95
SAND STONE

KA-1-89
LA-1-96
TEAL OPAL

KA-1-90
LA-1-97
SILVER LINING





KS-1-75 BLUE MIST



KS-1-77 BLUE CLOUD



KS-1-80 TEAL HORIZON

KS-1-74 ROSE GARDEN



KS -1-76 MAUVE ROSE



KS-1-78 SATIN WOOD



KA-1-91
LA-1-98
BLUSHING CORAL

KA-1-92
LA-1-99
STERLING BLUE

KA-1-93
LA-1-100
CAMEO ROSE





LONDON AIRE MINI HOME GALLEY



LONDON AIRE LAMBREQUIN



LONDON AIRE OPTIONAL CERAMIC FLOOR



LONDON AIRE MINI HOME
OVERHEAD ENTERTAINMENT CENTER

MOTORIZED Standards and Options

MI	MI	MI	MI	CA	CA	CA	CA		
DS	KS	KA	LA	DS	KS	KA	LA	RETAIL	CHASSIS FEATURES cont.
NA	NA	NA	NA	O	O	O	O	\$385	Chassis-Ford (460 CID Engine) w/Radial Tires w/78 Gal. Tank
NA	NA	NA	NA	O	O	O	O	\$984	Chassis-Oshkosh (460 CID Ford Engine) w/Radial Tires w/90 Gal. Tank
NA	NA	NA	NA	O	O	O	O	\$6463	Chassis-Oshkosh (Diesel) w/Radial Tires w/90 Gal. Tank
S	S	S	S	S	S	S	S		Cruise Control
S	S	S	S	S	S	S	S		Heater/Air Conditioner High Output Automotive
NA	NA	S	S	NA	NA	NA	NA		Power Window & Door Locks Driver & Passenger
S	S	S	S	S	S	S	S		Power Steering
NA	NA	NA	NA	NA	NA	S	S		Steering Wheel Custom Simulated Leather (Chevy)
S	S	S	S	S	S	S	S		Steering Wheel Tilt
S	S	S	S	S	S	S	S		Transmission Automatic
S	S	S	S	S	S	S	S		Transmission Cooler
O	O	NA	NA	NA	NA	NA	NA	\$171	Transmission Cooler Auxiliary (Chevy cutaway chassis)
S	S	S	S	NA	S	S	S		Transmission Cooler Auxiliary (except Chevy cutaway chassis)
S	S	S	S	S	S	S	S		Windshield Tinted
S	S	S	S	S	S	S	S		Intermittent Wipers
ELECTRICAL & LIGHTING EQUIPMENT									
NA	NA	NA	NA	NA	NA	NA	S		Battery 115 AMP Sears Die Hard Deep Cycle (2)
S	S	S	S	S	S	S	NA		Battery 115 AMP Sears Die Hard Deep Cycle
NA	NA	NA	NA	O	O	O	NA	\$124	Battery 115 AMP Sears Die Hard Deep Cycle Extra
NA	NA	O	S	O	O	O	S	\$247	Battery Disconnect
O	O	O	S	O	O	O	S	\$304	CB Radio w/Antenna
NA	S	NA	NA	NA	S	NA	NA		Converter 40 AMP w/Charger
S	NA	NA	NA	S	NA	NA	NA		Converter 45 AMP w/Charger
NA	NA	S	NA	NA	NA	S	NA		Converter 50 AMP w/Charger
NA	NA	O	S	NA	NA	O	S	\$128	Converter 75 AMP w/Charger
NA	NA	NA	O	NA	O	O	O	\$342	Inverter
S	S	S	S	S	S	S	NA		Electrical Service 30 AMP
NA	O	O	O	NA	O	O	S	\$219	Electrical Service 50 AMP
NA	O	O	O	NA	O	O	NA	\$159	Electrical Service Prep for 50 Amps
NA	NA	NA	NA	S	NA	NA	NA		Gen. 2.8 kw Onan w/1 Remote Sw.
NA	NA	O	S	NA	NA	S	NA	\$2,612	Gen. 4.0 kw Onan w/1 Remote Sw. & Auto. Changeover
NA	NA	NA	NA	O	NA	NA	NA	\$1,014	Gen. 4.0 kw Onan ILO Standard
O	O	NA	NA	NA	O	NA	NA	\$2,612	Gen. 4.0 kw Onan w/1 Remote Switch
NA	NA	NA	NA	NA	O	NA	NA	\$4,005	Gen. 6.5 kw Onan w/1 Remote Switch
NA	NA	NA	NA	NA	NA	S	NA		Gen. 6.5 kw Onan w/2 Remote Sw. & Auto. Changeover
NA	NA	NA	O	NA	NA	O	NA	\$1,335	Gen. 6.5 kw Onan ILO Std.
NA	NA	NA	NA	O	O	O	O	\$689	Gen. LP Conversion
S	S	NA	NA	NA	NA	NA	NA		Gen. Prep (110 V/wire, remote start wire & door)
NA	NA	NA	NA	NA	S	NA	NA		Gen. Prep (auto. changeover, 110V wire, remote start wire & door)
NA	NA	S	NA	NA	NA	NA	NA		Gen. Prep (auto. changeover, 12V cable, remote start wire & door)
NA	NA	NA	NA	O	O	S	S	\$110	Horn Trumpet (on roof)
NA	NA	NA	NA	O	O	S	S	\$369	Light Remote Controlled (roof spot/flood)
NA	O	NA	NA	NA	O	NA	NA	\$57	Lighting Fluorescent Dbl. Surface Mount (ea.) (Choose Location)
NA	NA	NA	NA	NA	O	O	S	\$284	Lights Docking (Recessed in Side)
NA	O	O	O	O	O	O	O	\$39	Light Exterior Security (ea.) (Choose Location)
NA	O	O	S	O	O	O	S	\$114	Lights Fog
NA	NA	S	S	NA	NA	S	S		Lights in Wardrobe w/Automatic Switches
NA	NA	NA	S	NA	NA	S	S		Lights Interior Courtesy
S	S	S	S	S	S	S	S		Monitor Panel
NA	NA	NA	O	NA	NA	NA	O	\$1,286	Stereo AM/FM Cass., Clock & Compact Disc ILO Std.
NA	NA	NA	NA	NA	NA	NA	S		Radio/Ant., AM/FM Stereo Cass., Clock & 2 Speakers (bedroom)
S	S	S	S	S	S	S	S		Radio/Ant., AM/FM Stereo Cass., Clock
S	S	S	S	S	S	S	S		Recept. 110V GFI (interior & exterior)
NA	NA	O	O	NA	NA	O	O	\$17	Recept. 110V (extra) (Choose Location)
NA	O	O	O	O	S	S	S	\$64	Switch for Emergency Chassis Engine Start
NA	O	O	O	NA	O	O	O	\$44	Telephone Jack Interior (Ea., Choose Location)
NA	NA	NA	S	NA	NA	NA	S	\$64	Telephone Hook-up w/1 Jack
S	O	S	S	S	S	S	S	\$193	TV Antenna w/Power Booster & Jack(s)

MI	MI	MI	MI	CA	CA	CA	CA		
DS	KS	KA	LA	DS	KS	KA	LA	RETAIL	ELECTRICAL & LIGHTING EQUIPMENT cont.
NA	NA	NA	S	O	S	S	S	\$331	TV Color AC 13" w/Remote Control
NA	NA	NA	NA	NA	NA	NA	S		TV Color AC/DC 9" w/Remote Control
NA	O	O	S	NA	O	O	S	\$43	TV Jack Exterior on Door Side
NA	NA	O	O	NA	NA	O	O	\$53	TV Jack w/Splitter (extra) (Choose Location)
NA	NA	NA	NA	NA	O	O	S	\$2,040	TV Monitor Closed Circuit Rear View & Back Up Lights
NA	S	S	S	O	S	S	S	\$44	TV Cable Hook Up
NA	O	O	NA	O	O	O	NA	\$83	VCR Prep (where applic.)
NA	NA	O	S	O	O	O	S	\$512	VCR w/Newmar Tape
NA	NA	NA	NA	O	O	O	O	\$3,595	TV Satellite Dish 6' (where applic.)
EXTERIOR ACCESSORIES									
S	S	S	NA	S	NA	NA	NA		Bumper Cover Aluminum
S	NA	NA	NA	S	NA	NA	NA		Bumper w/Sewer Hose Storage
NA	S	S	S	NA	S	S	S		Exterior Front & Rear Gelcoated Fiberglass End Caps
NA	S	S	S	NA	S	S	S		Exterior Sides Gelcoated Fiberglass (per ft.)
O	O	O	S	O	O	O	S	\$179	Roof Rack & Ladder
NA	NA	NA	NA	NA	NA	O	NA	\$229	Mirrors Exterior w/Convex, Remote Control, Defrost & Turn Sign
NA	NA	NA	NA	NA	O	S	NA	\$118	Mirrors Exterior w/Convex & Defrost
NA	NA	NA	NA	O	O	NA	S	\$555	Mirrors Exterior w/Convex, Remote Control, Defrost & Turn Sign
NA	NA	O	S	NA	NA	O	S	\$24	Roof Gelcoated Fiberglass (per ft.)
O	S	S	NA	S	S	S	NA	\$292	Roof Rubber
S	NA	NA	NA	NA	NA	NA	NA		Roof One Piece Aluminum
S	NA	NA	NA	NA	S	S	S		Exterior Graphics Deluxe
S	S	S	NA	NA	NA	NA	NA		Running Boards Aluminum
NA	NA	NA	S	NA	NA	NA	NA		Running Boards Fiberglass
NA	NA	NA	NA	NA	O	O	O	\$2,687	Slide Out 65" in Rear Bedroom (where applic.)
NA	NA	NA	NA	NA	O	O	O	\$3,519	Slide Out 65" w/Hide-A-Bed in Living Room (where applic.)
NA	NA	NA	NA	O	S	S	S	\$97	Step Fold Down in Front Bumper
O	O	S	O	S	O	S	S	\$246	Step 12 Volt Auto. w/Non Skid Surface
NA	NA	NA	S	NA	NA	NA	S		Storage Exterior Slide Out Drawer 29"
NA	NA	NA	NA	NA	NA	NA	S		Storage Exterior Slide Out Drawer 48"
NA	NA	NA	O	NA	NA	NA	O	\$310	Storage Roof Pod 10 cu ft.
NA	NA	NA	O	NA	NA	NA	O	\$460	Storage Roof Pod 21 cu ft.
INTERIOR FEATURES									
S	S	S	S	S	S	S	S		Bedsprad Quilted w/Matching Shams
NA	S	S	S	NA	S	S	S		Ceiling Woven Soft Touch
NA	NA	NA	S	NA	NA	NA	S		Countertop Corian Kitchen, Fixed Dinette & Bath
NA	O	O	NA	NA	O	O	NA	\$253	Countertop Ceramic Tile
NA	NA	S	S	NA	S	S	S		Floor Covering, Carpet w/Deluxe Pad Throughout
S	S	NA	NA	S	S	NA	NA		Floor Covering, Carpet w/ Pad Throughout
NA	O	O	O	NA	O	O	O	\$437	Floor Covering, Hardwood Parquet in Kitchen Area ILO Carpet
NA	O	O	NA	NA	O	O	NA	\$41	Floor Covering, Vinyl in Kitchen Area ILO Carpet
NA	NA	NA	NA	NA	NA	NA	O	\$837	Floor Covering, Ceramic Tile in Bath Area ILO Carpet
NA	NA	NA	S	NA	NA	NA	S		Window Garnish (Residential Style)
NA	S	NA	NA	S	S	NA	NA		Window Treatmt. Mini Blinds
NA	NA	S	S	NA	NA	S	S		Window Treatmt. Mini Blinds (Kitchen & Bath)
NA	S	NA	NA	NA	S	NA	NA		Window Treatmt. Roller Shades w/Drapes/Val. & Tie Backs (Bedrm.)
NA	NA	S	S	NA	NA	S	S		Window Treatmt. Day/Night Soft Shades, Lambrequins (Liv. & Bedrm.)
NA	O	NA	NA	NA	S	NA	NA	\$1,170	XL Package Interior & Exterior
NA	O	NA	NA	NA	S	NA	NA		XL Bath Accessories Brass
NA	O	NA	NA	NA	S	NA	NA		XL Bath Lav. & Tub Faucet Deluxe Brass
NA	O	NA	NA	NA	S	NA	NA		XL Kitchen Faucet Single Handle Brass
NA	O	NA	NA	NA	S	NA	NA		XL Bifold Range Cover
NA	O	NA	NA	NA	S	NA	NA		XL Black Glass Door & Larger Oven
NA	O	NA	NA	NA	S	NA	NA		XL Black Glass Door on Refer
NA	O	NA	NA	NA	S	NA	NA		XL Deluxe Brass Complexion Light in Bathroom w/Wall Switch
NA	O	NA	NA	NA	S	NA	NA		XL Deluxe Din. Light w/Wall Switch

MOTORIZED Standards and Options

MI	MI	MI	MI	CA	CA	CA	CA	RETAIL	INTERIOR FEATURES cont.
DS	KS	KA	LA	DS	KS	KA	LA		XL Deluxe Raised Panel Doors ILO Std.
NA	O	NA	NA	NA	S	NA	NA		XL Sofa Throw Pillows
NA	O	NA	NA	NA	S	NA	NA		XL Lifts for Convenient Storage Under Fixed Beds
NA	O	NA	NA	NA	S	NA	NA		XL Step Single 12 Volt Auto. ILO Std.
PLUMBING SYSTEMS									
NA	NA	O	O	NA	O	O	O	\$224	Heat Pads for Holding Tanks 110V
NA	O	O	O	NA	O	O	O	\$275	Insulated Holding Tanks
NA	NA	O	S	NA	NA	O	S	\$89	Sewage Holding Tank Rinse
S	S	S	S	NA	NA	NA	NA		Tank Gray Water 25 Gal. (Approx.)
NA	NA	NA	NA	S	S	S	S		Tank Gray Water 30 Gal. (Approx.)
NA	NA	NA	NA	NA	S	S	NA		Tank Gray Water 70 Gal. (Approx. SS models)
S	S	S	S	NA	NA	NA	NA		Tank Sewage Holding 25 Gal. (Approx.)
NA	NA	NA	NA	S	S	S	NA		Tank Sewage Holding 28 Gal. (Approx.)
NA	NA	NA	NA	NA	NA	NA	S		Tank Sewage Holding 48 Gal. (Approx.)
NA	NA	NA	NA	NA	S	S	NA		Tank Sewage Holding 70 Gal. (Approx. SS models)
S	S	S	S	NA	NA	NA	NA		Water Capacity 27 Gal. (Approx.)
NA	NA	NA	NA	S	NA	NA	NA		Water Capacity 30 Gal. (Approx.)
NA	NA	NA	NA	NA	S	S	S		Water Capacity 54 Gal. (Approx.)
NA	NA	NA	NA	NA	NA	NA	S		Water Hose w/Auto. Rewind w/City Water Hook-up
S	S	S	S	S	S	S	S		Water System Demand w/12V Pump & 5/8" Polybutylene Lines
RUNNING GEAR & CONSTRUCTION									
O	O	O	S	O	O	O	S	\$323	Hitch for Towing Car w/Wire Connector
NA	NA	NA	S	NA	NA	NA	S		Insulation 1/4" Fome-Cor Exterior Roof
NA	NA	NA	NA	NA	S	S	NA		Insulation 1/4" Fome-Cor Floor + Ends (w/fiberglass sides)
NA	NA	S	S	NA	NA	S	S		Insulation R19 Fiberglass in Roof
NA	S	S	S	S	S	S	S		Insulation Laminated 5/8" Foam in Sidewalls & Ceiling
NA	O	NA	NA	NA	O	NA	NA	\$174	Insulation Polar Pak (R7 Sidewalls & Floor-R10 Roof)
NA	NA	S	S	NA	NA	S	S		Insulation R7 Fiberglass in Sidewalls
S	S	NA	NA	S	S	NA	NA		Insulation R5 Fiberglass in Sidewalls, Roof & Floor
NA	NA	S	S	S	S	S	S		Jack Hydraulic - 6 Ton
NA	NA	NA	NA	NA	NA	NA	S		Jacks Hydraulic Auto. Levelling
NA	NA	NA	O	O	O	S	NA	\$3,105	Jacks Hydraulic Levelling
NA	NA	NA	NA	S	S	S	S		Mud Flaps (front & rear)
S	S	S	S	S	S	S	S		Shock Absorbers
NA	S	S	S	S	S	S	S		Skid Bars for Rear Bottom Protection
S	S	S	NA	S	NA	NA	NA		Spare Tire Carrier
O	O	S	NA	S	NA	NA	NA	\$103	Spare Tire Cover Deluxe (27" & up)

MI	MI	MI	MI	CA	CA	CA	CA	RETAIL	RUNNING GEAR & CONSTRUCTION cont.
DS	KS	KA	LA	DS	KS	KA	LA		Spare Tire in Bumper Slide Out Tray (where applic.)
NA	NA	NA	S	NA	S	S	S		Spare Tire
O	S	S	S	S	S	S	S	\$291	Structure Aluminum Sidewalls & Roof
S	S	S	S	S	S	S	S		Suspension w/Mor Ryde Tag Axle
NA	NA	NA	NA	NA	NA	NA	NA		Suspension w/Mor Ryde Tag Axle (33" & up)
NA	NA	NA	NA	NA	S	S	S		Air Adjustable Helper Springs
O	O	O	O	NA	NA	NA	NA	\$368	Air Adjustable Helper Springs
S	S	S	S	S	S	S	S		Undercoating
S	S	S	S	S	S	S	NA		Wheel Covers Decorative Deluxe
NA	NA	NA	NA	O	O	O	NA	\$54	Wheel Simulator Deluxe Stainless ILO Std. (ea.)
NA	NA	NA	NA	NA	NA	NA	S		Wheels Polished Aluminum
SAFETY FEATURES									
NA	O	O	O	NA	O	O	O	\$725	Customer Pick Up
NA	O	O	S	NA	O	O	S	\$60	LP Leak Detector
NA	NA	O	O	NA	NA	O	O	\$1,703	Security System
O	O	O	O	O	O	O	O		State Seal
WINDOWS, DOORS, AWNINGS & VENTS									
NA	NA	O	O	NA	NA	O	O	\$209	Awning Per Window Matching Side Awning (Choose Location) Deluxe
NA	NA	O	NA	NA	NA	O	NA	\$144	Awning Per Window Matching Side Awning (Choose Location)
O	O	O	NA	O	O	O	NA	\$827	Awning Side
NA	O	O	S	NA	O	O	S	\$1,031	Awning Side Deluxe
NA	O	O	O	NA	O	O	O	\$93	Awning Tension Rafter for Side Awning
NA	O	O	S	NA	O	O	S	\$38	Door Bell
NA	NA	NA	NA	O	O	S	S	\$1,256	Door Driver Side w/Power Window & Pass Side Panel
NA	NA	NA	S	NA	NA	NA	NA		Door Stop Auto. Flush Recessed (one)
NA	NA	NA	S	NA	NA	NA	S		Grab Handle Deluxe w/Light & Inside Switch
S	S	NA	NA	S	S	NA	NA		Lock Dead Bolt (ea)
NA	O	O	S	O	O	O	S	\$190	Skylight in Bathroom w/Soft Shade (27" & up)
NA	O	NA	NA	NA	O	NA	NA	\$43	Vent Non Power (Choose Location)
NA	NA	NA	NA	O	NA	NA	NA	\$32	Vent in Ceiling 12V ILO Std w/Wall Switch
S	S	S	S	S	S	S	S		Vent 12V in Bath Area w/Wall Switch
NA	O	O	O	NA	O	O	O	\$91	Vent 12V in Ceiling w/Wall Switch (Choose Location)
NA	O	O	O	NA	O	O	O	\$311	Vent 12V Fantastic 3-Spd. w/Wall Thermostat & Power Opener (Choose Location)
S	S	NA	NA	NA	S	NA	NA		Windows Radius Slider Clamp in Safety Glass
NA	NA	S	S	NA	S	S	S		Windows Radius Slider Tinted Safety Glass
NA	NA	NA	NA	S	NA	NA	NA		Windows Radius Clamp in Safety Glass

MODEL	FACTORY WEIGHT*	GVWR#	FRONT AXLE*	REAR AXLE*	TIRES	WHEELS	HEIGHT W/AC	LENGTH	WIDTH	OPTION
DS 25WCB CA	10,900	16,000	4,300	6,600	8R X 19.5D	19.5 X 6	11' 9"	25' 10"	95"	
DS 27WCB CA	11,200	16,000	4,200	7,000	8R X 19.5D	19.5 X 6	11' 9"	28' 6"	95"	
DS 31CBD CA	11,850	16,000	3,900	9,300	8R X 19.5D	19.5 X 6	11' 9"	32' 3"	95"	
KA-KS 27 WCB-CA	12,470	16,000	4,100	8,370	8R X 19.5D	19.5 X 6	11' 2-3/4"	29' 4"	93"	A
KA-KS 31 CBD-CA	12,620	16,000	3,800	8,820	8R X 19.5D	19.5 X 6	11' 2-3/4"	32' 6"	93"	B
KA-KS 33 CBD/SS-CA	15,070	18,500	4,150	10,920	8R X 19.5D	19.5 X 6	12' 1"	34' 7"	93"	C,E,I
KA-KS 37 SACB/SS-CA	16,370	18,500	4,100	12,270	8R X 19.5D	19.5 X 6	12' 1"	37' 11"	93"	D,E,H
LA 37 WCSA/SS-CA	16,370	18,500	4,100	12,270	8R X 19.5D	19.5 X 6	12' 1"	37' 11"	96"	E,G
LA 37 WCB/SS-CA	16,200	18,500	4,500	11,700	8R X 19.5D	19.5 X 6	12' 1"	37' 3"	96"	E,F

* NO OPTIONS

RATING IS FOR STANDARD CHASSIS

**Shown with SS Option

MOTORIZED LEGEND

FLOOR PLANS

CB - Center Bath
 CBD - Center Bath Dinette
 RBRD - Rear Bath w/Rear Door
 RBT - Rear Bath Twin Bed
 SACB - Side Aisle Center Bath
 WCB - Walk through Center Bath
 WCB/SS - Walk through Center Bath w/Dinette
 WCSA - Walk through Center Bath w/Side Aisle

Specifications

CA - Class "A" (Motorhome)
 Dbl. - Double
 ILO - In Lieu Of
 DS - Dutch Star
 KA - Kountry Aire
 KS - Kountry Star
 LA - London Aire
 MI - Mini Home (Mini Motorhome)
 NA - Not Applicable
 O - Option

CLASS A FLOOR PLANS 1991

DS 25 WCB

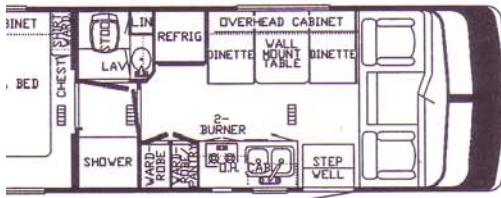

KA & KS 37 SACB/SS

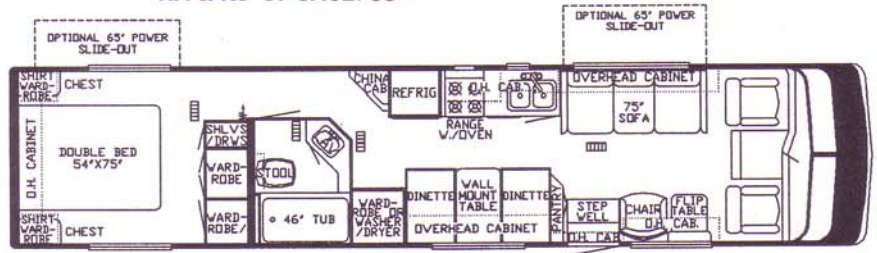

DS 27 WCB

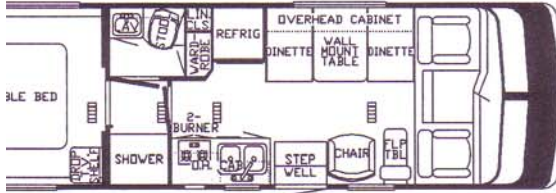

LA 37 WCB/SS

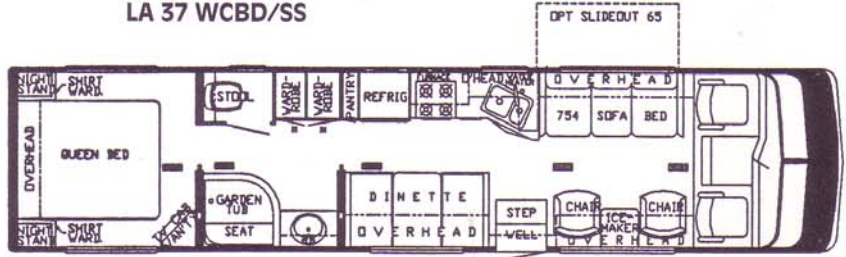

DS 31 CBD

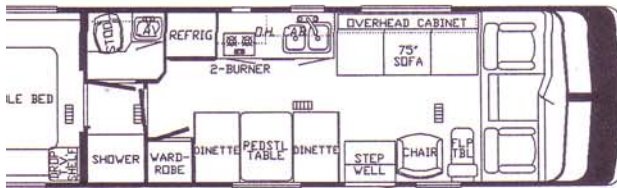

LA 37 WCSA/SS

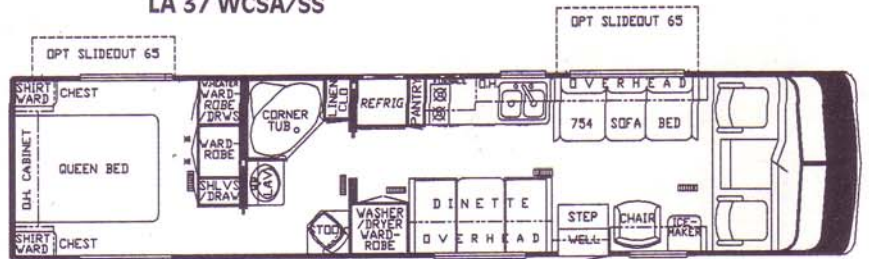

KA & KS 27 WCB/SS**

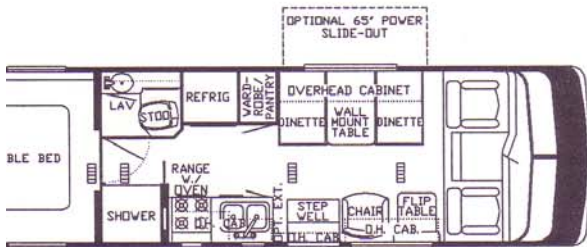

OPTIONS

OPTION A

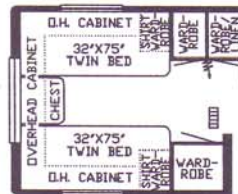

OPTION B

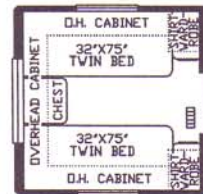

OPTION C



KA & KS 31 CBD/SS**

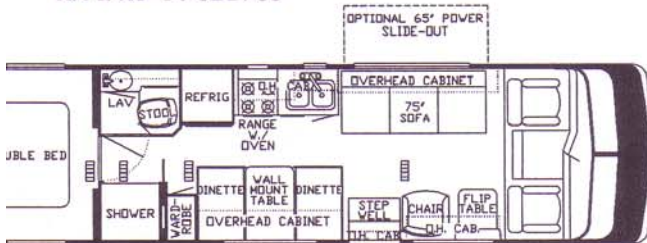

OPTION D

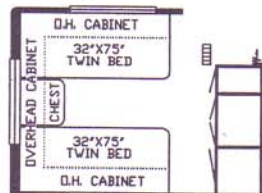

OPTION E



OPTION F



KA & KS 33 CBD/SS

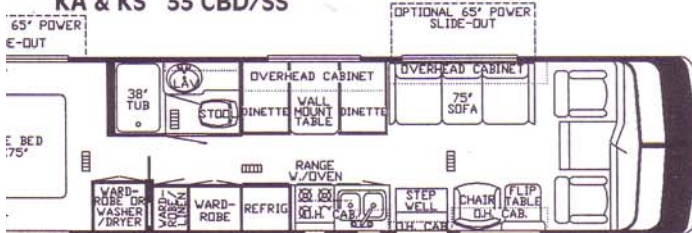

OPTION G

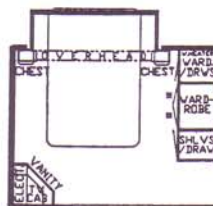

OPTION H

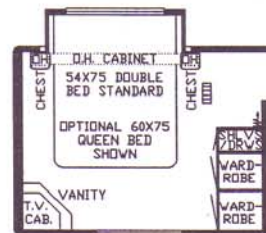

OPTION I

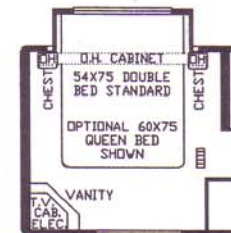

MINI HOME FLOOR PLANS 1991

LA 28 RBRD

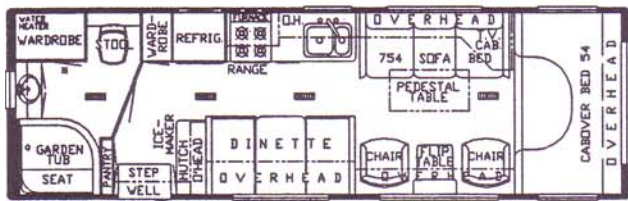

LA 28 WCB

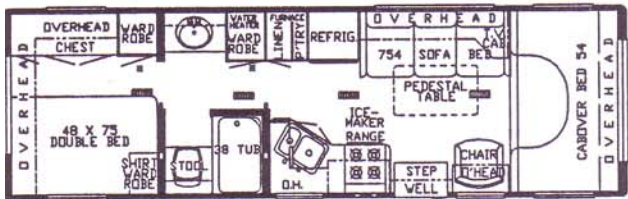

KS 22 RK

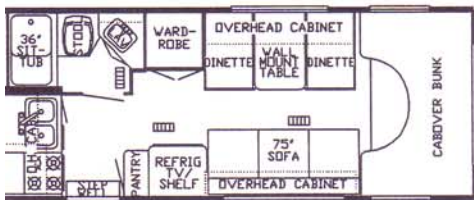

KA & KS 27 WCB

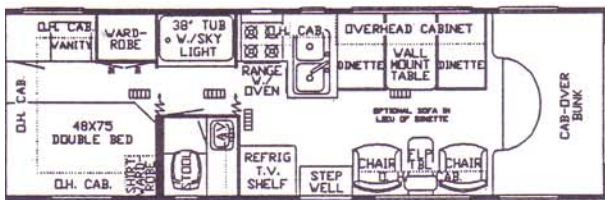

KA & KS 27 CB

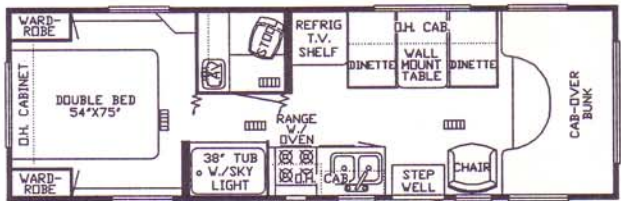

DS 22 RK

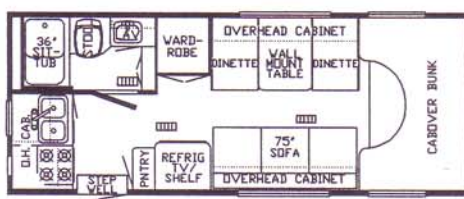

DS 27 CB

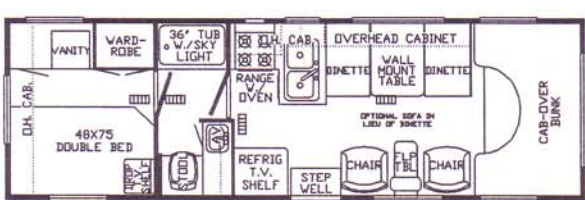

DS 27 WCB

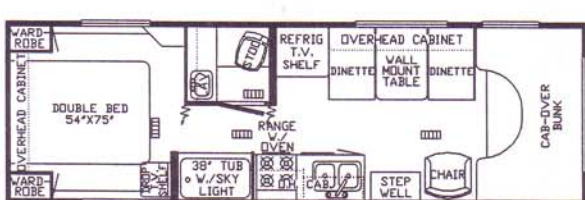

OPTIONS

OPTION A

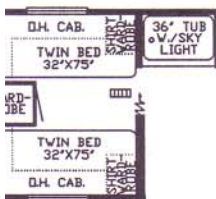

OPTION B

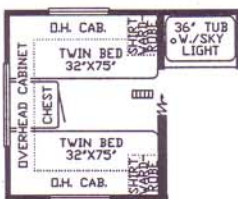

OPTION C



OPTION D

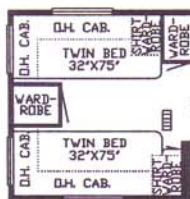

OPTION E

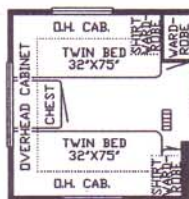

OPTION F

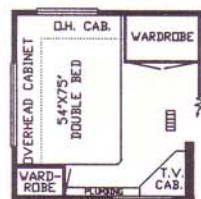

MODEL	FACTORY WEIGHT*	GVWR#	FRONT AXLE*	REAR AXLE*	TIRES	WHEELS	HEIGHT W/AC	LENGTH	WIDTH	OPTION
DS 22 RK-MH	8,600	10,500	3,000	5,600	8.00 x 16.5D	16.5 X 6	10' 6"	22' 1"	95"	
DS 27 CB-MH	9,350	11,000	3,200	6,150	215/85R 16D	16 X 6	10' 6"	28' 2"	95"	
DS 27 WCB-MH	9,400	11,000	3,200	6,200	215/85R 16D	16 X 6	10' 6"	28' 3"	95"	
KS 22 RK-MH	8,550	10,500	3,000	5,500	800 X 16.5D	16.5 X 6	10' 6"	21' 9"	95"	
KA-KS 27 CB-MH	9,135	11,000	3,200	5,935	215/85R 16D	16 X 6	10' 6"	28' 1"	95"	A,B,C
KA-KS 27 WCB-MH	9,185	11,000	3,200	5,985	215/85R 16D	16 X 6	10' 6"	28' 3"	95"	D,E,F
LA 28 RBRD-MH	11,700	15,000	3,400	8,300	215/85R 16D	16 X 6	11' 2"	28' 8"	93"	
LA 28 WCB-MH	11,900	15,000	3,500	8,400	215/85R 16D	16 X 6	11' 2"	28' 8"	93"	

* NO OPTIONS

RATING IS FOR STANDARD CHASSIS

Newmar Kountry Klub

"Don't forget to check out the Klub...the Newmar Kountry Klub that is. All you need to be eligible is to be the proud owner of any one of the fine Newmar products!"

Get the Carefree
SPIRIT **hydro flame**
Coleman **MOR/ryde** **SHARP**
RECREATIONAL VEHICLE PRODUCTS

Newmar Corporation features appliances and components by these quality names to insure you of years of safe and trouble-free operation and enjoyment.



MOR/ryde

SUSPENSION

INSTRUMENT
PANEL



AWNING!



[Kountry Star] 



[Kountry Aire] 



[London Aire] 

1991



KOUNTRY STAR CLASS A



NEW POWER SOFA (STANDARD IN LONDON AIRE CLASS A & MINI HOME)

*NOT AVAILABLE WITH POWER SLIDE OUT.

Your nearest Newmar dealer:



*Newmar Corporation:
A sound company backed by
23 years of experience*



1991 Motorhomes

Newmar Corporation, 355 N. Delaware St.
Nappanee, IN 46550-0030, (219) 773-7791

Scheduled plant tours Monday-Friday

Prices and specs are subject to change without written notice at Newmar's discretion
with no obligation.