

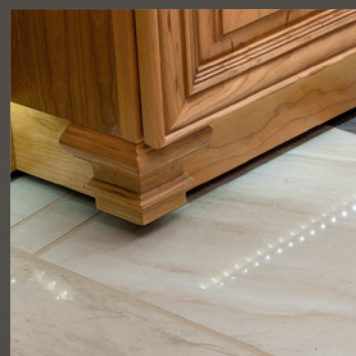

2014  
**MOUNTAIN AIRE**  
*Luxury Motor Coach*

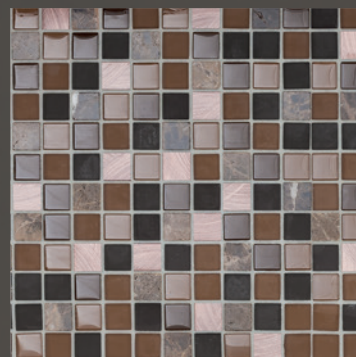



**Mountain Aire Exterior**  
*Floor plan #4369 in Diamond Exterior*





# 2014 Mountain Aire

Now every journey  
becomes an adventure.

Power. Comfort. Convenience. All come together in the 2014 Mountain Aire. You'll turn heads with the gorgeous exterior, highlighted by Newmar's Full-Paint Masterpiece™ Finish and a wealth of exquisite styling touches. And when the road beckons, you can effortlessly answer the call courtesy of the Cummins® 450HP diesel powertrain. Trust Mountain Aire to take you places in ways you never imagined.



WHEN YOU KNOW THE DIFFERENCE <sup>SM</sup>



***Class Inside and Out***

*The Mountain Aire's exterior amenities  
make it the center of attention.*



# Don't just live the dream. Drive it.

Whether on the road or off the beaten path, Mountain Aire offers extras at every turn. Advanced cockpit technology, including Newmar's Comfort Drive™ steering, makes driver control and navigation a breeze, while the rock-solid Freightliner® Custom Chassis XCR with 44,600 lb GVWR assures a smooth ride.



**Comfort Drive™**  
STEERING

And entertainment is made in the shade beneath a remote-activated Girard® power-side awning and optional exterior Sony® audio/video center with a stunning 40" HDTV that extends and swivels for best viewing.



**Driven By You**

*Freightliner Custom Chassis are renowned for their exceptional ride and handling, tight turning radius and extraordinary dependability.*

\*Optional



## ***Features at a glance:***

- Full-Paint Masterpiece™ Finish with Super Clear Coat
- Comfort Drive™ steering with adjustable control
- Exterior sidewall entertainment center with Sony® 40" LED TV\*
- Girard® power side awning with wind sensor and remote control





**Mountain Aire Interior**

*Floor plan #4369 with Arcadia Décor Style and Carmel Glazed Cherry Cabinetry – More Like Home Than Ever.*







# Step into an inviting new definition of comfort.

The Mountain Aire interior is alive with the colors and comforts of home. The surfaces of Newmar's hand-crafted hardwood cabinetry now flow in natural curves, while a custom inlay porcelain floor mirrors the feeling of movement and life. Behind solid-surface countertops and a deep, residential-style stainless steel sink, the marble and glass backsplash glows with a shimmer of iridescence. Everywhere you look, the good life just got better.

## ***Features at a glance:***

- Polished solid surface countertops in kitchen, bath and bedroom
- Carmel Glazed Cherry hardwood unitized cabinets
- Polished porcelain floor tile in kitchen, bathroom and living areas
- Residential refrigerator with icemaker and water dispenser

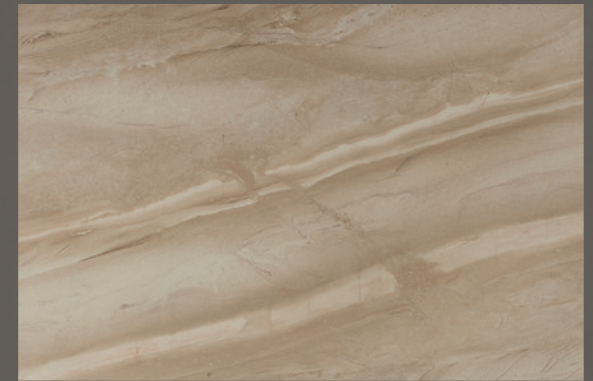
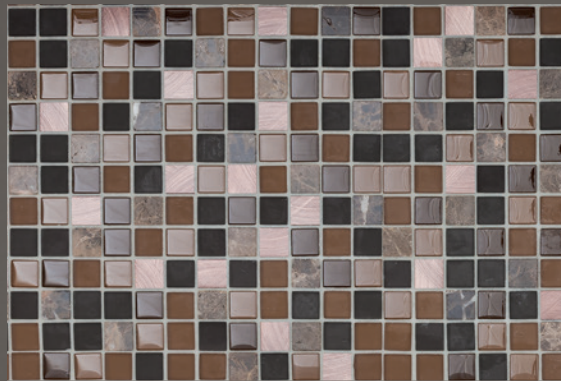







# Entertain with a whole new perspective.

Mountain Aire gives you an entirely new way to enjoy the view. A handy counter bar overlooks the patio area, providing a picturesque perspective while you enjoy coffee or conversation. And for an ideal living room space, reversible seating at the counter and cockpit seats—along with a perfectly positioned sofa and nearby Euro-booth dinette—creates a cozy den.

Or if you prefer a more spectacular window view, activate the televator screen to reveal a 46" Sony HDTV.\* With Newmar, there's not a bad seat in the house.

## **Features at a glance:**

- Sony® 46" LED HDTV on televator\*
- Bar dinette and Villa® Euro dinette\*\*
- Power duo day/night privacy window shades
- Villa Ultralux sofa and driver/passenger seats



\* Standard on floor plan #4369. Check dealer for floor plan availability.

\*\* Optional

***The Heart of the Home*** ►

*At motion and at rest, the cockpit is Mountain Aire's center of activity.*







# A bedroom so gorgeous, you'll hate to close your eyes.

Every detail of the Mountain Aire master bedroom speaks to the kind of craftsmanship and quality you'll only find with the Newmar name. The mood is set with lighting from backlit mica-based fascia panels that project a warm glow while you relax on the king size Sleep Number® Bed\* with canopy-style overhang. Slip in a favorite DVD to enjoy on the Sony 32" HDTV entertainment center. Or turn your bedroom suite into a guest lounge with the option of a power-adjustable bed that folds to reveal practical and family safe seating to watch TV on and off the road.

## ***Features at a glance:***

- Sony® 32" LED HDTV with DVD
- King bed with radius corners
- Power bed/sofa base converts to private family safe seating\*
- Sleep Number® premier mattress\*
- Multiplex lighting control system

\* Optional



***Rest Up for Adventure*** ►

*With Mountain Aire's quarters, you'll always be ready for what tomorrow's road brings.*











## The finest ways to freshen up.

Mountain Aire's master bath is a clean break from the expected. The residential size shower includes the remarkable new Delta® IN2ITION® integrated showerhead and sprayer, plus solid surface walls with stylishly modern glass and marble accent panels. You'll also find those patterns mirrored in the backsplash listello tiles that serve to complement the room's double sink vanities—a Mountain Aire first.

### ***Features at a glance:***

- Solid surface shower with glass door
- Dual bathroom vanity sinks with listello backsplash
- Demand water system
- Fold down shower seat\*



- ◀ **Left:** Full his-and-hers sink vanities to maximize space and comfort.
- ◀ **Right:** Residential shower for the most luxurious, refreshing experience possible.

\*Optional



MOUNTAIN AIRE EXTERIOR DÉCOR



Diamond Exterior

---



Platinum Exterior

---



Bullion Exterior

---



Mineral Exterior

---



## MOUNTAIN AIRE INTERIOR DÉCOR

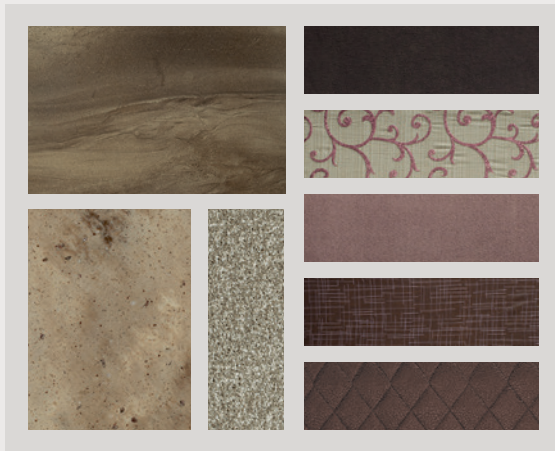

Pembroke Interior



Arcadia Interior

## WOOD OPTIONS



Sable Maple



Wicker Glazed Maple



Augusta Interior

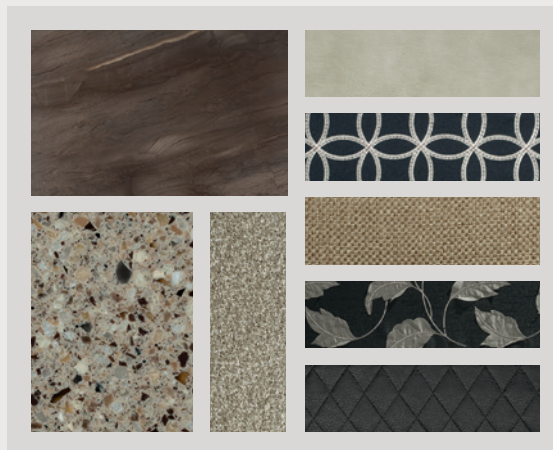

Hemlock Interior

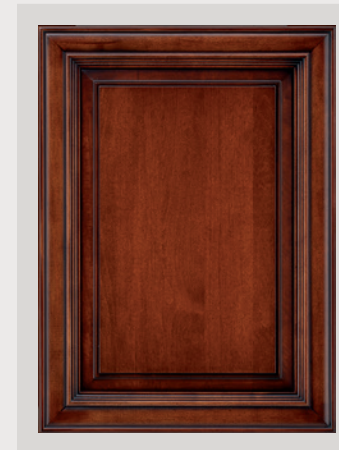

Manhattan Glazed Maple



Carmel Glazed Cherry



## MOUNTAIN AIRE FLOOR PLANS

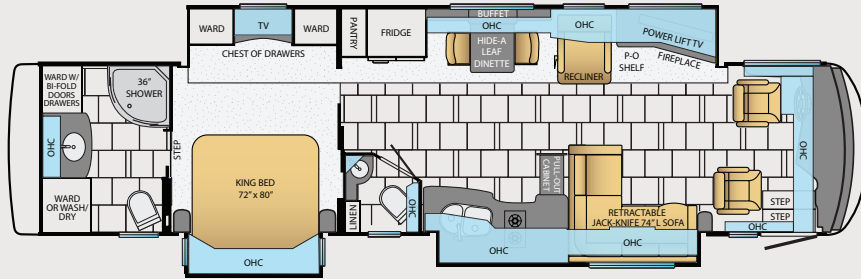

4018

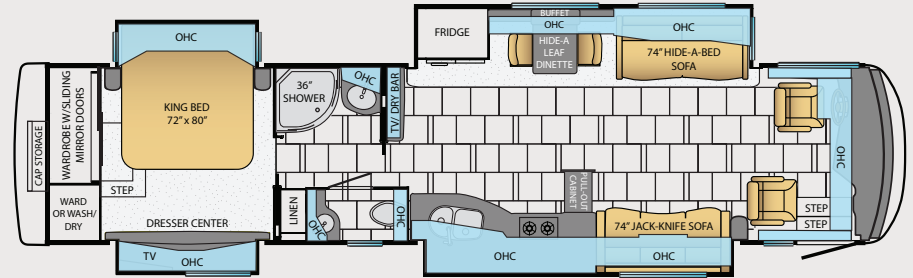

4038

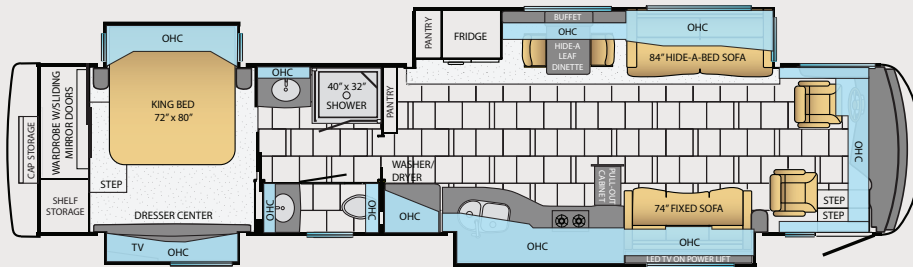

4360

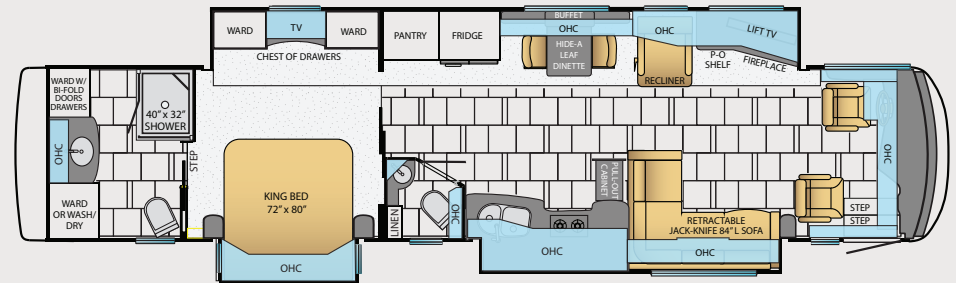

4361

## FLOOR PLAN SPECIFICATIONS

Floor Plan	App. Overall Length	Width	App. Overall Height	Interior Width	Interior Height	Grey Tank	Sewage Tank	Water Tank	Propane Tank	Furnace
4018	40'9"	101.5"	12'10"	95.5"	84"	65 gal.	45 gal.	105 gal.	32 gal.	50,000 btu
4038	40'9"	101.5"	12'10"	95.5"	84"	65 gal.	45 gal.	105 gal.	32 gal.	50,000 btu
4360	43'9"	101.5"	12'10"	95.5"	84"	65 gal.	45 gal.	105 gal.	32 gal.	50,000 btu
4361	43'9"	101.5"	12'10"	95.5"	84"	65 gal.	45 gal.	105 gal.	32 gal.	50,000 btu



## MOUNTAIN AIRE FLOOR PLANS

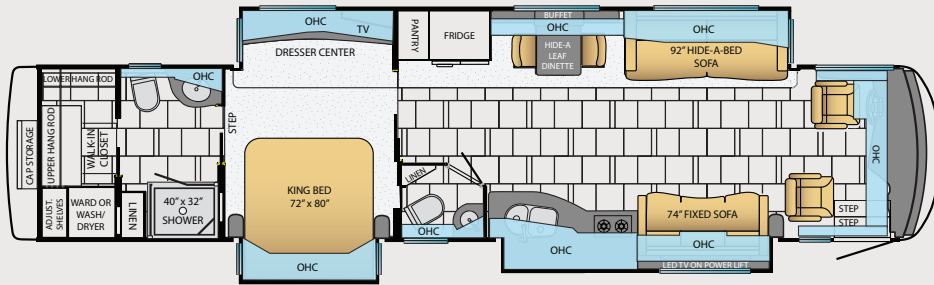

4364

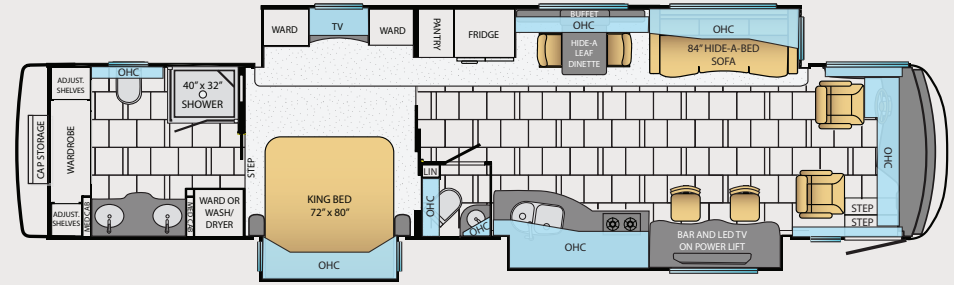

4369

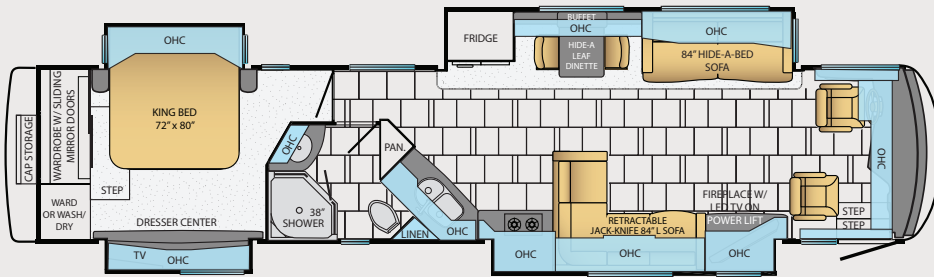

4372

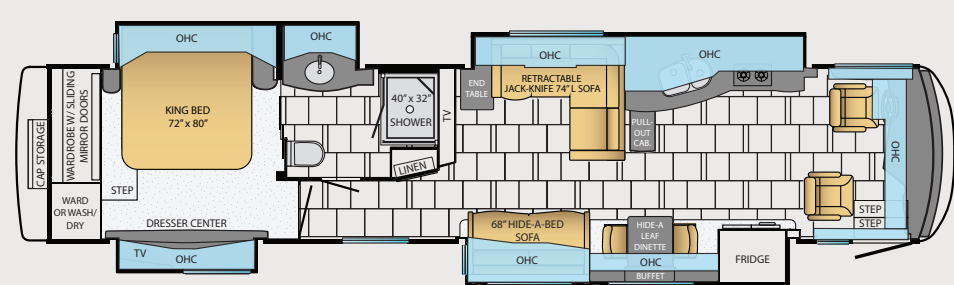

4374

## FLOOR PLAN SPECIFICATIONS

Floor Plan	App. Overall Length	Width	App. Overall Height	Interior Width	Interior Height	Grey Tank	Sewage Tank	Water Tank	Propane Tank	Furnace
4364	43'9"	101.5"	12'10"	95.5"	84"	65 gal.	45 gal.	105 gal.	32 gal.	50,000 btu
4369	43'9"	101.5"	12'10"	95.5"	84"	65 gal.	45 gal.	105 gal.	32 gal.	50,000 btu
4372	43'9"	101.5"	12'10"	95.5"	84"	65 gal.	45 gal.	105 gal.	32 gal.	50,000 btu
4374	43'9"	101.5"	12'10"	95.5"	84"	65 gal.	45 gal.	105 gal.	32 gal.	50,000 btu



# MOUNTAIN AIRE FEATURES & OPTIONS



## Chassis Features

*Built specifically for Newmar with the highest quality in handling, safety, performance, and dependability.*

Freightliner® Tag Axle XCR Chassis with 450hp Cummins ISL Engine

Adjustable Pedals

Aluminum Wheels with Trim Kit

Cruise Control

Back-Up Alarm

Electronic Chassis Information in Display in Dash

Anti-Lock Braking System

Hydraulic Leveling Jacks with Single Touch Control

Comfort Drive™ Steering With Adjustable Control

Recessed Fuel Fills with Crossover to Fill from Either Side

### OPTIONS

TripTek™ Electronic Travel Information (Displayed on Rearview Monitor)

Vorad™ Adaptive Cruise System



## Air Conditioning & Heating

*Total Comfort Air Conditioning and Hydronic Zone Heating systems make climate control simple and effective.*

Hydronic Zone Heating System

Two 15M Penguin™ Heat Pump Central Air Conditioners

Propane Gas Leak Detector

Roof Air Conditioning Drainage System

Dash Heater and High Output Air Conditioner

Driver and Passenger Dash Overhead Ventilation System

Wall Mounted Sensors for Heating & Air Conditioning

### OPTIONS

Extra 15M Penguin™ Heat Pump Central Air Conditioner with 10.0 kW Onan® Generator\*

Electric Heat under Floor Tile in Kitchen, Bath, and Living Areas



## Appliances & Accessories

*All of the amenities of a fine home are integrated in the Newmar design, in both form and capabilities.*

Polished Solid Surface Range Cover

Compact One-Piece Washer/Dryer Prep

Microwave 30" Convection with Two Burner Gas Cooktop

Fireplace in Living Room Area\*

Air Horns

### OPTIONS

Dometic® Freezer on Pullout Tray\*

Whirlpool® Two-Piece Stacked Washer/Dryer\*

All Electric-Maytag® Refrigerator, 2 Burner Cooktop & 4 Extra Batteries\*

All Electric-Whirlpool® Refrigerator, 2 Burner Cooktop & 4 Extra Batteries\*

Maytag® Refrigerator with Icemaker, Water Dispenser & 2 Extra Batteries\*

Whirlpool® Refrigerator with Icemaker, Water Dispenser & 2 Extra Batteries\*

Dishwasher in Drawer Located Below Cooktop

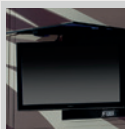

## Audio, Video & Accessories

*Stay entertained on the road and off, with spectacular visual and sound options from industry leaders.*

Two Bedroom Radio Speakers

Sony® LED TV and DVD Player in Living and Bedroom\*

AM/FM Dash Radio with CD Player and Auxiliary Jack

Rearview Color Monitor System with Audio

Sony® Surround Sound System with Sub-Woofer

High Definition Component Wiring

Infra-Red Reapter System to Operate Audio/Video Components

Roof Mounted Digital TV Antenna with Power Booster

### OPTIONS

Sony® 40" LED TV in Front Overhead Cabinet\*

Sony® 46" LED TV on Televator

Sirius Satellite Radio Capability (Does not include monthly subscription)

Universal Remote Control

Exterior Entertainment Center in Sidewall with Sony® 40" LED TV

Exterior Entertainment Center Located in Storage Compartment with 32" Sony® LED TV and Sony® AM/FM Radio and CD Player\*

Satellite Dish

Central Vacuum with Deluxe Tool Kit

Winegard Power Lift Digital TV Antenna

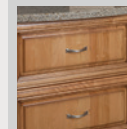

## Cabinets & Furniture

*Amish craftsmanship and elegance in design meld the wood cabinetry and furniture seamlessly with the Newmar interior.*

Sable Maple Hardwood Cabinets with Concealed Hinges and Full Overlay Double Cathedral Doors

Pullout Pantry Shelves\*

Drawers with Full Extension Guides

Dinette Styles Vary, See Floor plans for Availability\*

Polished Solid Surface Countertop in Kitchen, Bath, and Bedroom Areas

Villa® Ultra Leather Sofa and Driver/Passenger Seats

Heated Front Seats with Power Lumbar, Power Footrest and Oversized Passenger Seat

Cedar Paneling in Bedroom Wardrobe

King-Sized Bed with Radius Cornered Mattress

Lifts On Bed Top

Plush Pillow Top Mattress

Passenger Seat Work Station

Concealed Hinges on Cabinet Doors

### OPTIONS

Carmel Glazed Cherry Hardwood Cabinets

Manhattan Glazed Maple Hardwood Cabinets

Wicker Glazed Maple Hardwood Cabinets

Extenda L Sofa

Villa® Euro Dinette

Villa® Extenda Flex Dinette

Non Sleeper Sofa

Power Bed/Sofa Base with Sleep Number® Premier Air Mattress

Sleep Number® Premier Air Mattress for Main Bed

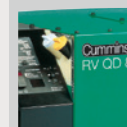

## Electrical Features

*A Newmar coach's electrical and lighting system is designed for maximum reliability, functionality, and style.*

8.0 kW Cummins Onan® Quiet Series Diesel Generator on Hydraulic Slideout Tray

50 Amp Electrical Service with Flexible Cord

Four 6 Volt House Batteries



Energy Management System
Multiplex™ Electrical Wiring System
2800 Watt Inverter
Midship Side Turn Signals
Recessed Docking Lights
Halogen Lights Recessed in Ceiling and Overhead Cabinets
Lighted Wardrobe
ICC Light Flasher Switch
Battery Disconnect Switch
Mood Lighting Recessed in Feature Ceiling, Slideout Fascia, Lambrequins, Kitchen, Bed Base & Dash
Solar Prep
Power Cord Rewind Reel with 50' Cord
110 Volt Exterior Recept
12 Volt Auxiliary Recept on Dash
5 Watt Solar Panel
Automatic Generator Start on Low Battery or Temperature Setting
Emergency Engine Start Switch
Engine Block Heater
Exterior Security Lights
Manually Operated Hold-To-Run Slideout Switch
Recept with Built in USB Charger at Dinette & Bedroom Dresser Cabinet
Secondary Multiple Touch Screen in Bedroom

#### OPTIONS

8 AGM House Batteries-Available Only with the All Electric Option
LED Interior Lighting

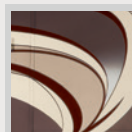

### Exterior Features

*The Full-Paint Masterpiece Finish is one of the most beautiful and durable in the industry, with the goal of a perfect finish, every time.*

Chrome Convex Exterior Mirrors with Remote Control, Defrost, Turn Signal Indicators, and Sideview Cameras
Power Locking Baggage Doors
Automatic Height compensating Step for Entrance Door
Keyless Entry with Door Bell and Touch Pad
Rear Hitch for Towing Car
Assist Handle at Entrance Door
Stainless Steel Kick Panel at Entrance Door

Rear Protective Tow Guard with Stainless Steel
Lighted Exterior Storage Compartments with Cargo Liner
Mud Flaps
Chrome Trim Package
Undercoating

#### OPTIONS

Large Storage Tray with Access from One Side or Either Side*
Large Storage Tray*
Power Sliding Storage Tray*

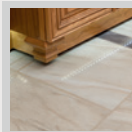

### Interior Features

*Flooring – both tile and carpet – is installed with Newmar's own in-house process, ensuring the best in quality and longevity, as well as the finest fit.*

Front Entrance Door with Power Stepwell Cover
Interior Assist handle at Main Entry Door
Auto Motion Power Dual Window Shades & Lambrequins
Auto Motion Power Shades for Windshield and Driver/Passenger Side Windows
Hardwood Fascia on Living Area Slideouts and Window Sills
Polished Porcelain Floor Tile in Kitchen, Bathroom, and Living Areas
Carpeting on Slideout Floors
Hardwood Raised-Panel Interior Passage Doors
Designer Feature Ceiling
Shoe Storage Shelves Recessed into Rear Cap Wardrobe
Quilted Comforter with Shams and Accent Pillows
10 Bc Fire Extinguisher, Smoke Detector and Carbon Monoxide Detector

#### OPTIONS

Power Silhouette Window Shades
Polished Porcelain Floor Tile Extended into Bedroom

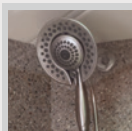

### Plumbing & Bath Features

*The Demand Water System's residential flow response ensures that the comfort and reliability of home are never far away.*

Solid Surface Shower Walls with Glass Door
Water Filter for Entire Unit

Dometic® Traveler China Bowl Stool in Center Bathroom (Macerator Stool in Rear Bath)*
Exterior Shower
Monitor Panel
Sewage Holding Tank Rinse
Automatic Fill for Fresh Water Tank

#### OPTIONS

Assist Handle in Shower
Fold-Down Shower Seat
RV Sanicon System
Power Water Hose Reel



### Windows, Vents & Awnings

*Experience as much – or as little – of the outdoors as you want in comfort and style.*

Frameless Double-Pane Tinted Safety-Glass Windows
Fan-Tastic® Vent with Rain Sensor in Kitchen Area and Bathroom
Shower Skylight
Girard® Slideout Covers, Power Awnings on Windows and Entrance Door
One Piece Tinted Windshield

#### OPTIONS

Additional Girard® Power Side Awning
Drivers Side Power Window

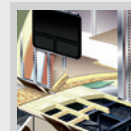

### Construction Features

*From the chassis on up, Newmar coaches are built to be dependable, durable, comfortable, and beautiful.*

5/8" Foam Insulation
Mechanical Lock Arms on All Slideout Rooms
Fiberglass Roof with Walkable Decking
Aluminum-Frame Sidewalls & Roof Construction, 16" on Center
Polar Pak R19 Batten Insulation in Roof

\*Check with dealership on floor plan availability and complete listing of features.



## MOUNTAIN AIRE CONSTRUCTION

The Freightliner® XCR's strong chassis with 50,000 PSI frame rail provides Mountain Aire with a solid, confident foundation. This – and Mountain Aire's GVWR of 44,600 pounds, with a 10,000 pound tag axle, allows Mountain Aire to expand beyond its chassis footprint, creating extra living space. Its Cummins® ISL 450 HP engine gives you incredible maneuverability and power, even on steep inclines. And if you should ever need it, Newmar's roadside assistance program is in place for the entire warranty period.



### ROOF R-VALUE = 19

- a. Fiberglass Roof
- b. Fiberglass Batten Insulation
- c. A/C Ducting
- d. Aluminum Rafter Framing
- e. Kraft Paper Vapor Barrier
- f. 5/8" Bead Foam
- g. 3/16" Panel
- h. Padded Vinyl Overlay

### FLOOR R-VALUE = 16

- o. Carpet/Tile
- p. Carpet Padding
- q. 5/8" Floor Decking
- r. Fiberglass Batten Insulation
- s. 2"x 3" Wood Framing
- t. Polyethylene Moisture Barrier

### BASEMENT R-VALUE = 4

- u. Cargo Liner
- v. 3/8" Floor Decking
- w. 3/16" Luan Panel
- x. 1 1/2" Bead Foam
- y. Aluminum Sheeting with Steel Support Rails to Prevent Bowing and Flexing

### SIDEWALL R-VALUE = 11

- i. 3/16" Plywood Interior Wall
- j. 5/8" Bead Foam
- k. Kraft Paper Vapor Barrier
- l. Fiberglass Batten Insulation
- m. Composite One-Piece Gelcoat Exterior Sidewall
- n. Aluminum Framing with 3 1/2" Header Above

- 1. 15M Penguin™ Heat Pump Central Air Conditioners
- 2. One-Piece Bonded Windshield
- 3. Coated Aluminum Wheels
- 4. Frameless, Double-Pane, Tinted Safety-Glass Windows
- 5. Side-Hinged Baggage Doors with Optional Storage Tray

Floor Plan	Engine HP	Axle Ratio	Fuel Cap.	Wheel Base	Front GAWR*	Rear GAWR*	Tag GAWR*	GVWR*	GCWR*	App. UVW	App. NCC
4018	450	4.63	150	252+TAG	17,000 lb	20,000 lb	10,000 lb	44,600 lb	59,600 lb	36,400 lb	8,200 lb
4038	450	4.63	150	252+TAG	17,000 lb	20,000 lb	10,000 lb	44,600 lb	59,600 lb	36,400 lb	8,200 lb
4360	450	4.63	150	288+TAG	17,000 lb	20,000 lb	10,000 lb	44,600 lb	59,600 lb	37,300 lb	7,300 lb
4361	450	4.63	150	288+TAG	17,000 lb	20,000 lb	10,000 lb	44,600 lb	59,600 lb	37,400 lb	7,200 lb
4364	450	4.63	150	288+TAG	17,000 lb	20,000 lb	10,000 lb	44,600 lb	59,600 lb	37,800 lb	6,800 lb
4369	450	4.63	150	288+TAG	17,000 lb	20,000 lb	10,000 lb	44,600 lb	59,600 lb	38,400 lb	6,200 lb
4372	450	4.63	150	288+TAG	17,000 lb	20,000 lb	10,000 lb	44,600 lb	59,600 lb	37,900 lb	6,700 lb
4374	450	4.63	150	288+TAG	17,000 lb	20,000 lb	10,000 lb	44,600 lb	59,600 lb	38,000 lb	6,600 lb

Lengths, heights, widths and dry weights are approximate. Weight will vary based on optional equipment added to the above base weight.

**GAWR:** Gross Axle Weight Rating is the maximum permissible weight for an axle.

**GVWR:** Gross Vehicle Weight Rating is the maximum permissible weight for a fully loaded motor coach.

**GCWR:** Gross Combination Weight Rating is the value specified by the manufacturer of the vehicle as the maximum allowable loaded weight of this motor coach and any towed trailer or towed vehicle.

**UVW:** Unloaded Vehicle Weight is the weight of this motorcoach as built at the factory with full fuel, engine oil and coolants. The UVW does not include cargo, fresh water, propane gas or dealer-installed accessories.

**NCC:** Net Carrying Capacity is the maximum weight of all occupants, including the driver, personal belongings, food, fresh water, waste water, propane gas, tools, tongue weight of towed vehicle, dealer-installed accessories, etc., that can be carried by the motor coach.

\*Specifications supplied by the chassis manufacturer.



# Trust.

## The strongest possible foundation for a motor coach.

According to Newmar president Matthew Miller, "Customers say they're loyal to us because they trust us to stand behind our products – from support, parts and service to paying our warranties. It feels good to own a coach that has all of that behind it."

How do we sustain this high level of service? At Newmar, there's a Miller way of doing things. These principles guide us every day. Courtesy. Integrity. And reliability. So when you buy from Newmar, you know that every single person who touches your coach or talks with you has your back. Period.

## Our Partners.

### Where the finest names in quality and performance are along for the ride.

Newmar strives to offer the best motor coach experience possible, and to that end we partner with the most prestigious names in mobile lifestyle, entertainment, and technology. Depending on the Newmar motor coach you choose, our compliments range from Sony's comprehensive audio, video, communications and information technology to Freightliner and Spartan's superior and dependable chassis designs. Newmar only accepts best-in-class performance from the most trusted names in the business. At Newmar, that's our difference. And our promise.

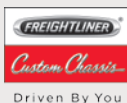

**SONY**



▲ Mahlon Miller, Newmar founder, and Matthew Miller, Newmar president, lifelong motor coach enthusiasts





## 2014 Mountain Aire

### **NEWMAR EXPRESS LIMITED WARRANTY**

Every Mountain Aire Diesel Pusher is backed by Newmar's one-year limited warranty/unlimited miles. Ask your Newmar dealer for details.

### **LIMITED FIVE-YEAR STRUCTURAL WARRANTY**

If any part of your Newmar recreational vehicle superstructure (which is the steel/aluminum structure of the sidewall, roof or frame) fails to perform properly within five years from the date of purchase because of faulty workmanship or material supplied by Newmar, it will be repaired without charge for either parts or labor by Newmar. This structural warranty is available only to the original purchaser and is non-transferable.

*Some features in our literature are optional. Colors and finishes are photographic representations. The actual materials may look different. Prices, specifications and floor plans are subject to change at Newmar's discretion, without prior notice or obligation. Please see your dealer for actual samples and specifications.*



WHEN YOU KNOW THE DIFFERENCE <sup>SM</sup>

NEWMAR CORPORATION  
355 N DELAWARE ST  
PO BOX 30  
NAPPANEE IN 46550-0030  
574-773-7791 Fax 574-773-2895  
[www.newmarcorp.com](http://www.newmarcorp.com)